

## Shutters/Blinds Actuator CJAE-01/01

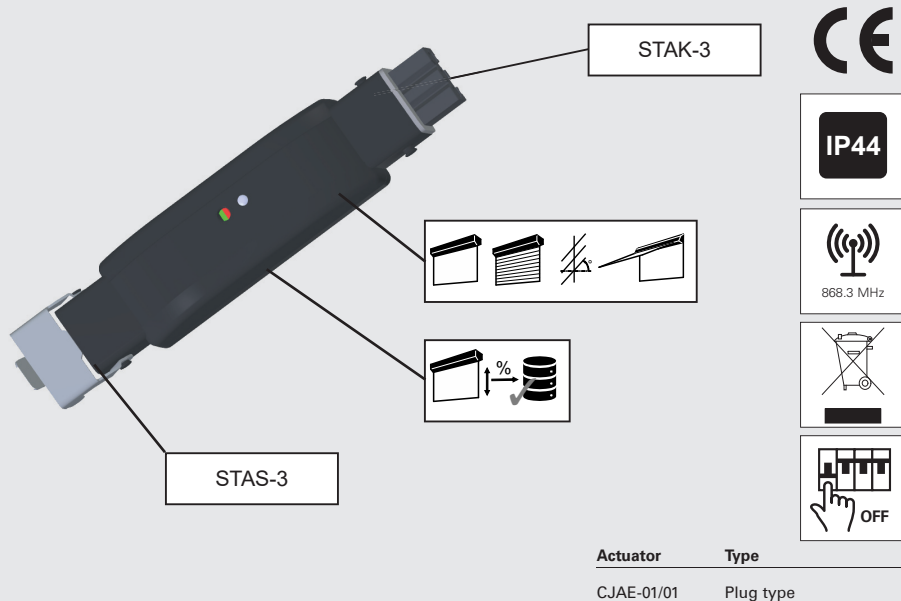

### Technical Data / Technische gegevens / Tekniske data / Technische Daten / Technická data

Power supply	230 VAC +10% -15%, 50 Hz
Load	3 A, L/R
Power standby	< 230 mW (Typical)
Protection	Overload, Over-temperature
Dimensions	27,5 x 32 x 125 mm (H x W x L)
RF	868.3MHz (xComfort compatible)
Max RF power	25 mW (ERP)

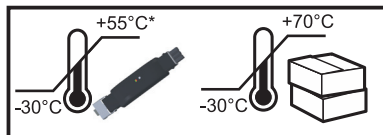

[www.eaton.com/comfort](http://www.eaton.com/comfort)



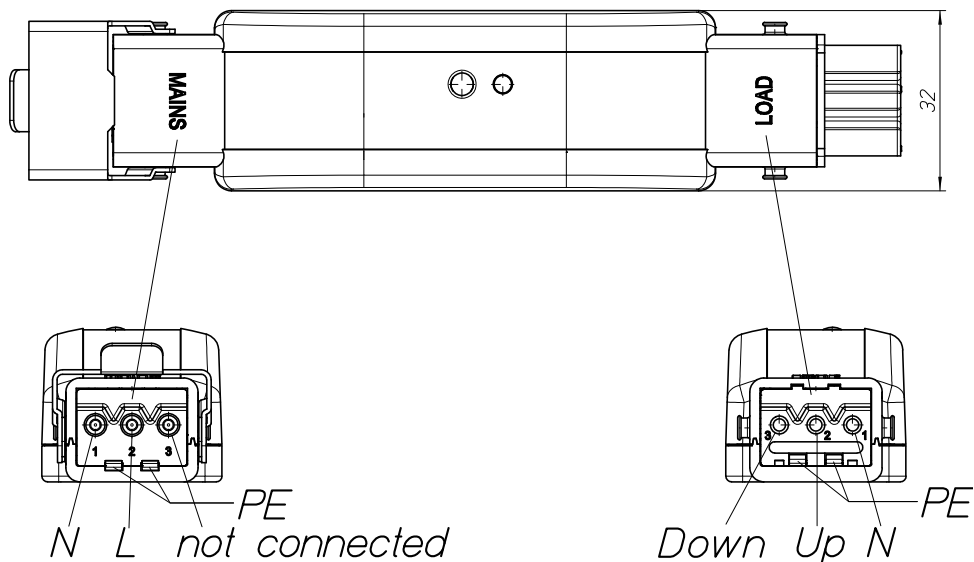

**Basic mode**

**Assign Sensor in Basic Mode\*** / Sensor in Basic Mode toewijzen / Tilknytte i Basic Mode / Zuweisen im Basic Mode / Přiradit v základním režimu



**Remove Sensor in Basic Mode\*** / Sensor in Basic Mode verwijderen / Fjerne i Basic Mode / Löschen im Basic Mode / Odstranit v základním režimu



**\*Not possible when assigned to xComfort Bridge** / Niet mogelijk indien toegewezen aan 'xComfort Bridge' / Ikke mulig når den er tilordnet 'xComfort Bridge' / Nicht möglich bei Zuordnung zu 'xComfort Bridge' / Není možné, pokud je přiřazen k 'xComfort Bridge'



**Configure application mode** / Toepassingsmodus configureren / Konfigurer applikasjonsmodus / Anwendungsmodus konfigurieren / Konfigurace režimu aplikace

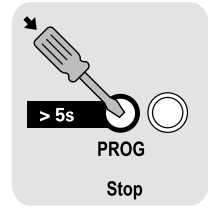
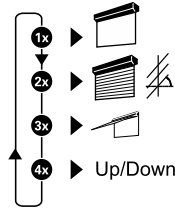
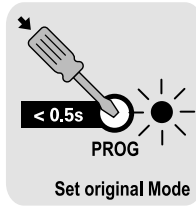
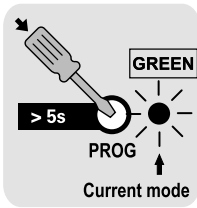

**Identify in MRF** /  
 Identifieren in MRF /  
 Identiser i MRF /  
 Identifizieren im MRF /  
 Identifikace v MRF

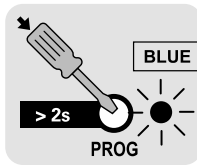

**Back to factory default** /  
 Terug naar fabrieksinstellingen /  
 Tilbake til fabrikkinnstillinger /  
 Auf Auslieferungszustand zurücksetzen /  
 Zpět na tovární hodnoty

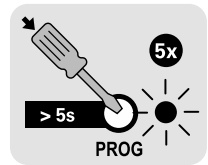
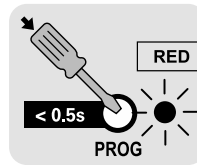



# Declaration of Conformity

We, EATON Industries (Austria) GmbH  
3943 Schrems, Eugenia 1  
Austria

declare under our sole responsibility as manufacturer that the product (family)

## Eaton - Shutters / Blinds Actuator Plug

### CJAE-01/01

(the declaration of conformity applies to all listed types within our actual product catalogue)

provided that it is installed, maintained and used in the application intended for, with respect to the relevant manufacturer's instructions, installation standards and "good engineering practices"

complies with the provisions of Council directive(s):

RED Directive 2014/53/EU

RoHS Directive 2011/65/EU + 2015/863

based on compliance with following standard(s):

EN 300220-2 V3.2.1, EN 301 489-1 V2.2.3, EN 301489-3 V2.1.1, EN IEC 63044-5-1:2019, EN IEC 63044-5-2:2019, EN IEC 63044-5-3:2019, EN 60669-2-5:2016, EN 63000:2018



Gerhard Dischner

Director Operations

Schrems, 11.11.2021

Friedrich Schröder

Director Quality

Affixing date of CE mark: 2021

Doc.Id.: CJAE\_01-01\_111121