



266031
N4-4-1250

[Overview](#)

[Specifications](#)

[Resources](#)



[Delivery program](#)

[Technical data](#)

[Design verification as per IEC/EN 61439](#)

[Technical data ETIM 7.0](#)

[Dimensions](#)

DELIVERY PROGRAM

Product range
Switch-disconnectors

Protective function
Disconnectors/main switches

Standard/Approval
IEC

Installation type
Fixed

Construction size
N4

Description
Main switch characteristics including positive drive to IEC/EN 60204 and VDE 0113.
Isolating characteristics to IEC/EN 60947-3 and VDE 0660.
Busbar tag shroud to VDE 0160 Part 100.

Number of poles
4 pole

Standard equipment
Screw connection

Switch positions
I, +, 0

Rated current = rated uninterrupted current [$I_n = I_u$]
1250 A

Short-circuit protection max. fuse gL-
characteristic
1600 A gL

TECHNICAL DATA

General

Standards
IEC/EN 60947

Protection against direct contact
Finger and back-of-hand proof to DIN EN
50274/VDE 0106 part 263

Climatic proofing
Damp heat, constant, to IEC 60068-2-78
Damp heat, cyclic, to IEC 60068-2-30

Ambient temperature
Ambient temperature, storage
- 40 - + 70 °C

Ambient temperature
Operation
-25 - +70 °C

Mechanical shock resistance (10 ms half-
sinusoidal shock) according to IEC 60068-2-27
15 (half-sinusoidal shock 11 ms) g

Safe isolation to EN 61140
Between auxiliary contacts and main contacts
500 V AC

Safe isolation to EN 61140
between the auxiliary contacts
300 V AC

Mounting position
Mounting position

Vertical and 90° in all directions

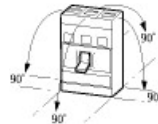

With residual-current release
XF:

- NZM1, N1, NZM2, N2: vertical
and 90° in all directions

with plug-in adapter elements

- NZM1, N1, NZM2, N2:
vertical, 90° right/left

with withdrawable unit:

- NZM3, N3: vertical, 90° left

- NZM4, N4: vertical

with remote operator:

- NZM2, N(S)2, NZM3, N(S)3,
NZM4, N(S)4: vertical and 90°
in all directions

Direction of incoming supply
as required

Degree of protection

Device

In the area of the HMI devices: IP20 (basic
protection type)

Degree of protection

Enclosures

With insulating surround: IP40

With door coupling rotary handle: IP66

Degree of protection

Terminations

Tunnel terminal: IP10

Phase isolator and band terminal: IP00

Switch-disconnectors

Rated surge voltage invariability [U_{imp}]

Main contacts

8000 V

Rated surge voltage invariability [U_{imp}]
Auxiliary contacts
6000 V

Rated operational voltage [U_e]
690 V AC

Rated operating frequency [f]
50/60 Hz

Rated current = rated uninterrupted current [$I_n = I_u$]
1250 A

Overvoltage category/pollution degree
III/3

Rated insulation voltage [U_i]
1000 V

Use in unearthed supply systems
 525 V

Other technical data (sheet catalogue)
Weight
Temperature dependency, Derating
Effective power loss

Rated short-circuit making capacity [I_{cm}]

690 V 50/60 H [I_c]
53 kA

Rated short-time withstand current

$t = 0.3$ s [I_{cw}]
25 kA

$t = 1$ s [I_{cw}]
25 kA

Rated conditional short-circuit current [kA]

With back-up fuse
N4-630...1600: 2 x 800 A gG/gL

400 ... 415 V
100 kA

690 V
80 kA

With downstream fuse
N4-630...1600: 2 x 800 A gG/gL

400 ... 415 V
100 kA

690 V
80 kA

Rated making and breaking capacity

Rated operational current [I_e]
AC-22/23A
415 V [I_e]
1250 A

Rated operational current [I_e]
AC-22/23A
690 V [I_e]
1250 A

Lifespan, mechanical [Operations]
10000

Max. operating frequency
60 Ops/h

Lifespan, electrical

AC-1
400 V 50/60 Hz [Operations]
3000

AC-1
415 V 50/60 Hz [Operations]

3000

AC-1
690 V 50/60 Hz [Operations]
2000

AC-3
400 V 50/60 Hz [Operations]
2000

AC-3
415 V 50/60 Hz [Operations]
2000

AC-3
690 V 50/60 Hz [Operations]
1000

Terminal capacity

Standard equipment
Screw connection

Optional accessories
Tunnel terminal
connection on rear
Strip terminal

Copper conductors and cables
Tunnel terminal
Stranded
4-hole
4 x (50 - 240) mm²

Copper conductors and cables
Bolt terminal and rear-side connection
Direct on the switch
Stranded
1 x (120 - 185)
4 x (50 - 185) mm²

Copper conductors and cables
Bolt terminal and rear-side connection
Module plate
Single hole [min.]
1 x (185 - 240) mm²

Copper conductors and cables
Bolt terminal and rear-side connection

Module plate
Single hole [max.]
2 x (70 - 185) mm²

Copper conductors and cables
Bolt terminal and rear-side connection
Module plate
Double hole [min.]
4 x 50 mm²

Copper conductors and cables
Bolt terminal and rear-side connection
Module plate
Double hole [max.]
4 x (35 - 185) mm²

Copper conductors and cables
Bolt terminal and rear-side connection
Connection width extension
Connection width extension
4 x 300
6 x (95 - 240) mm²

Al conductors, Al cable
Tunnel terminal
Stranded
4-hole
4 x (50 - 240)
mm²

Al conductors, Al cable
Bolt terminal and rear-side connection
Direct on the switch
Stranded
1 x (120 - 185)
4 x (50 - 185) mm²

Al conductors, Al cable
Bolt terminal and rear-side connection
Module plate
Single hole [min.]
1 x (185 - 240) mm²

Al conductors, Al cable
Bolt terminal and rear-side connection
Module plate
Single hole [max.]
2 x (70 - 185) mm²

Al conductors, Al cable
Bolt terminal and rear-side connection
Module plate
Double hole [min.]

4 x 50 mm²

Al conductors, Al cable
Bolt terminal and rear-side connection
Module plate
Double hole [max.]
4 x (35 - 185) mm²

Al conductors, Al cable
Bolt terminal and rear-side connection
Connection width extension
Connection width extension
2 x 240
6 x (70 - 240) mm²

Cu strip (number of segments x width x segment thickness)
Flat conductor terminal [min.]
6 x 16 x 0.8 mm

Cu strip (number of segments x width x segment thickness)
Flat conductor terminal [max.]
(2 x) 10 x 32 x 1.0 mm

Cu strip (number of segments x width x segment thickness)
Module plate
Single hole
(2 x) 10 x 50 x 1.0 mm

Cu strip (number of segments x width x segment thickness)
Bolt terminal and rear-side connection
Flat copper strip, with holes [min.]
(2 x) 10 x 50 x 1.0 mm

Cu strip (number of segments x width x segment thickness)
Bolt terminal and rear-side connection
Flat copper strip, with holes [max.]
(2 x) 10 x 50 x 1.0 mm

Cu strip (number of segments x width x segment thickness)
Bolt terminal and rear-side connection
Connection width extension
(2 x) 10 x 80 x 1.0 mm

Copper busbar (width x thickness) [mm]
Bolt terminal and rear-side connection
Screw connection

M10

Copper busbar (width x thickness) [mm]
Bolt terminal and rear-side connection
Direct on the switch [min.]
25 x 5 mm

Copper busbar (width x thickness) [mm]
Bolt terminal and rear-side connection
Direct on the switch [max.]
2 x (50 x 10) mm

Copper busbar (width x thickness) [mm]
Bolt terminal and rear-side connection
Module plate
Single hole [min.]
25 x 5 mm

Copper busbar (width x thickness) [mm]
Bolt terminal and rear-side connection
Module plate
Single hole [max.]
2 x (50 x 10)
mm

Copper busbar (width x thickness) [mm]
Bolt terminal and rear-side connection
Module plate
Double hole
2 x (50 x 10) mm

Copper busbar (width x thickness) [mm]
Bolt terminal and rear-side connection
Connection width extension
Connection width extension [min.]
60 x 10 mm

Copper busbar (width x thickness) [mm]
Bolt terminal and rear-side connection
Connection width extension
Connection width extension [max.]
2 x (80 x 10) mm

DESIGN VERIFICATION AS PER IEC/EN 61439

Technical data for design verification

Rated operational current for specified heat dissipation [I_n]
1250 A

Equipment heat dissipation, current-dependent [P_{vid}]
173 W

Operating ambient temperature min.
-25 °C

Operating ambient temperature max.
+70 °C

IEC/EN 61439 design verification

10.2 Strength of materials and parts
10.2.2 Corrosion resistance
Meets the product standard's requirements.

10.2 Strength of materials and parts
10.2.3.1 Verification of thermal stability of enclosures
Meets the product standard's requirements.

10.2 Strength of materials and parts
10.2.3.2 Verification of resistance of insulating materials to normal heat
Meets the product standard's requirements.

10.2 Strength of materials and parts
10.2.3.3 Verification of resistance of insulating materials to abnormal heat and fire due to internal electric effects
Meets the product standard's requirements.

10.2 Strength of materials and parts
10.2.4 Resistance to ultra-violet (UV) radiation
Meets the product standard's requirements.

10.2 Strength of materials and parts
10.2.5 Lifting
Does not apply, since the entire switchgear needs to be evaluated.

10.2 Strength of materials and parts
10.2.6 Mechanical impact

Does not apply, since the entire switchgear needs to be evaluated.

10.2 Strength of materials and parts

10.2.7 Inscriptions

Meets the product standard's requirements.

10.3 Degree of protection of ASSEMBLIES

Does not apply, since the entire switchgear needs to be evaluated.

10.4 Clearances and creepage distances

Meets the product standard's requirements.

10.5 Protection against electric shock

Does not apply, since the entire switchgear needs to be evaluated.

10.6 Incorporation of switching devices and components

Does not apply, since the entire switchgear needs to be evaluated.

10.7 Internal electrical circuits and connections

Is the panel builder's responsibility.

10.8 Connections for external conductors

Is the panel builder's responsibility.

10.9 Insulation properties

10.9.2 Power-frequency electric strength

Is the panel builder's responsibility.

10.9 Insulation properties

10.9.3 Impulse withstand voltage

Is the panel builder's responsibility.

10.9 Insulation properties

10.9.4 Testing of enclosures made of insulating material

Is the panel builder's responsibility.

10.10 Temperature rise

The panel builder is responsible for the temperature rise calculation. Eaton will provide heat dissipation data for the devices.

10.11 Short-circuit rating
Is the panel builder's responsibility. The specifications for the switchgear must be observed.

10.12 Electromagnetic compatibility
Is the panel builder's responsibility. The specifications for the switchgear must be observed.

10.13 Mechanical function
The device meets the requirements, provided the information in the instruction leaflet (IL) is observed.

TECHNICAL DATA ETIM 7.0

Low-voltage industrial components (EG000017) / Switch disconnecter (EC000216)

Electric engineering, automation, process control engineering / Low-voltage switch technology / Off-load switch, circuit breaker, control switch / Switch disconnecter (ecl@ss10.0.1-27-37-14-03 [AKF060013])

Version as main switch
Yes

Version as maintenance-/service switch
Yes

Version as safety switch
No

Version as emergency stop installation
Yes

Version as reversing switch
No

Number of switches
1

Max. rated operation voltage U_e AC
690 V

Rated operating voltage
690 - 690 V

Rated permanent current I_u
1250 A

Rated permanent current at AC-23, 400 V
0 A

Rated permanent current at AC-21, 400 V
0 A

Rated operation power at AC-3, 400 V
0 kW

Rated short-time withstand current I_{cw}
25 kA

Rated operation power at AC-23, 400 V
710 kW

Switching power at 400 V
0 kW

Conditioned rated short-circuit current I_q
0 kA

Number of poles
4

Number of auxiliary contacts as normally closed
contact
0

Number of auxiliary contacts as normally open
contact
0

Number of auxiliary contacts as change-over
contact
0

Motor drive optional
Yes

Motor drive integrated
No

Voltage release optional
Yes

Device construction
Built-in device fixed built-in technique

Suitable for ground mounting
Yes

Suitable for front mounting 4-hole
No

Suitable for front mounting centre
No

Suitable for distribution board installation
Yes

Suitable for intermediate mounting
Yes

Colour control element
Black

Type of control element
Rocker lever

Interlockable
Yes

Type of electrical connection of main circuit
Bolt connection

Degree of protection (IP), front side
IP20

Degree of protection (NEMA)

DIMENSIONS

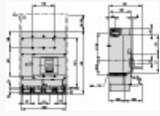

- Blow out area, minimum clearance to adjacent parts:
 - $U_i \leq 690 \text{ V}$: 100 mm
 - $U_i \leq 1500 \text{ V}$: 200 mm
- Minimum clearance to adjacent parts:
 - $U_i \leq 1500 \text{ V}$: 70 mm
 - $U_i \leq 1500 \text{ V}$: 70 mm



