

Select your language

- German
- English
- Spanish
- French
- Dutch
- Italian
- Polish
- Czech
- Russian
- Norwegian Bokmål

Worldwide English



NZM2-XKS - Screw connection 3p, standard, size 2



260030 NZM2-XKS

[Overview](#) [Specifications](#) [Resources](#)



## 260030 NZM2-XKS

Screw connection 3p, standard, size 2

EL-Nummer (Norway)

4358804

Optional accessories for the circuit-breaker series NZM offers a comprehensive portfolio of application options for use world wide. The mounting is always flexible and easy thanks to the modular function groups. Notes: part no. contains parts for a terminal located at top or bottom for 3 or 4 pole switches. Standard connection with all NZM2, FN2 and N2 circuit-breakers. Conversion kit for circuit-breaker with box terminal. Use special cable lug narrow version, fitted within the switch housing. If a busbar is used, insulation (400 mm) e.g. sleeving and a NZM2(4)-XKSA cover are required. U<sub>e</sub> □ 525 VAC. For all other connection material e.g. cables, flat conductors, a NZM2(-4)-XKSA shroud must be used. Can be used for: NZM2(-4), FN2(-4), N(NO)2(-4)

- [Delivery program](#)
- [Design verification as per IEC/EN 61439](#)
- [Technical data ETIM 7.0](#)
- [Approvals](#)
- [Dimensions](#)

### Delivery program

Number of conductors

3 pole

Accessories

Screw connection

Rated current [I<sub>n</sub>]

Cu 300, Al 250 A

For use with

NZM2, FN2, N(S)2

Terminal capacities

Type of conductor Cu/Al cable

Copper cable lugs

Aluminium cable lug

Terminal capacities flexible

1 x 10 - 185

2 x 4 - 70

1 x 10 - 50

2 x 10 - 50 mm<sup>2</sup>

AWG/kcmil

1 x 11 - 3/0

2 x 12

1 x 8 - 1/0

2 x 8 - 1/0 mm<sup>2</sup>

Terminal capacities

Cu strip (number of segments x width x segment thickness)

□ 2 x 16 x 0.8 mm<sup>2</sup>

Copper busbar width x thickness [Width]

□ 16 x 5 mm

**Notes**

Type contains parts for 3 or 4-pole switches on top or bottom of switch.

Standard connection with all NZM2, FN2 and N2 circuit-breakers.

Conversion kit for circuit-breaker with box terminal.

Use only specialized cable lugs with a narrow design; see NZM\*XKS\* types. Otherwise, NZM\*XKP phase disconnectors must be used, even for insulated cable lugs.

Fitted within the switch housing.

If a busbar is used, insulation (400 mm) e.g. sleeving and a NZM(-4)-XKSA cover are required.

$U_e \leq 525$  V AC.

- Bei allen anderen Anschlussmaterialien, z.B. Kabel, Bänder, ist eine Abdeckung NZM(-4)-XKSA zu verwenden.

## Design verification as per IEC/EN 61439

IEC/EN 61439 design verification

10.2 Strength of materials and parts 10.2.2 Corrosion resistance

Meets the product standard's requirements.

10.2 Strength of materials and parts 10.2.3.1 Verification of thermal stability of enclosures

Meets the product standard's requirements.

10.2 Strength of materials and parts 10.2.3.2 Verification of resistance of insulating materials to normal heat

Meets the product standard's requirements.

10.2 Strength of materials and parts 10.2.3.3 Verification of resistance of insulating materials to abnormal heat and fire due to internal electric effects

Meets the product standard's requirements.

10.2 Strength of materials and parts 10.2.4 Resistance to ultra-violet (UV) radiation

Meets the product standard's requirements.

10.2 Strength of materials and parts 10.2.5 Lifting

Does not apply, since the entire switchgear needs to be evaluated.

10.2 Strength of materials and parts 10.2.6 Mechanical impact

Does not apply, since the entire switchgear needs to be evaluated.

10.2 Strength of materials and parts 10.2.7 Inscriptions

Meets the product standard's requirements.

10.3 Degree of protection of ASSEMBLIES

Does not apply, since the entire switchgear needs to be evaluated.

10.4 Clearances and creepage distances

Meets the product standard's requirements.

10.5 Protection against electric shock

Does not apply, since the entire switchgear needs to be evaluated.

10.6 Incorporation of switching devices and components

Does not apply, since the entire switchgear needs to be evaluated.

10.7 Internal electrical circuits and connections

Is the panel builder's responsibility.

10.8 Connections for external conductors

Is the panel builder's responsibility.

10.9 Insulation properties 10.9.2 Power-frequency electric strength

Is the panel builder's responsibility.

10.9 Insulation properties 10.9.3 Impulse withstand voltage

Is the panel builder's responsibility.

10.9 Insulation properties 10.9.4 Testing of enclosures made of insulating material

Is the panel builder's responsibility.

10.10 Temperature rise

The panel builder is responsible for the temperature rise calculation. Eaton will provide heat dissipation data for the devices.

10.11 Short-circuit rating

Is the panel builder's responsibility. The specifications for the switchgear must be observed.

10.12 Electromagnetic compatibility

Is the panel builder's responsibility. The specifications for the switchgear must be observed.

10.13 Mechanical function

The device meets the requirements, provided the information in the instruction leaflet (IL) is observed.

## Technical data ETIM 7.0

Low-voltage industrial components (EG000017) / Wiring set for power circuit breaker (EC002050)

Electric engineering, automation, process control engineering / Low-voltage switch technology / Circuit breaker (LV < 1 kV) / Wiring set for circuit breaker (ecl@ss 10.0.1-27-37-04-24 [ACN957011])

Suitable for number of poles

3

Model  
Other

## Approvals

Product Standards  
UL489; CSA-C22.2 No. 5-09; IEC60947, CE marking  
UL File No.  
E31593  
UL Category Control No.  
DIHS  
CSA File No.  
022086  
CSA Class No.  
1432-01  
North America Certification  
UL listed, CSA certified  
Suitable for  
Refer to main component information

## Dimensions

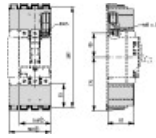

## CAD data

- [Product-specific CAD data](#)  
(Web)
- [3D Preview](#)  
(Web)

## DWG files

- [DA-CD-nzm2\\_xks](#)  
File  
(Web)

## Step files

- [DA-CS-nzm2\\_xks](#)  
File  
(Web)

## Dimensions single product

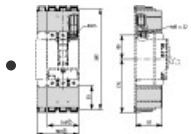

[123X319](#)

Line drawing

Shroud for screw terminals

3 pole

4 pole

## 3D drawing

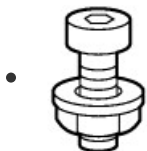

[123I673](#)

Line drawing

Screw connection

# Product photo



1230PIC-731  
Photo

# Instruction Leaflet

- [IL01206005Z](#)  
Asset  
(PDF, Language independent)

# Download-Center

- [Download-Center \(this item\)](#)  
Eaton EMEA Download-Center - download data for this item
- [Download-Center](#)  
Eaton EMEA Download-Center

[Generate data sheet in PDF format](#)

[Generate data sheet in Excel format](#)

[Write a comment](#)

[Imprint](#) [Privacy Policy](#) [Legal Disclaimer](#) [Terms and Conditions](#)

© 2022 by Eaton Industries GmbH