

Select your language

- German
- English
- Spanish
- French
- Dutch
- Italian
- Polish
- Czech
- Russian
- Norwegian Bokmål

Worldwide English



SL7/4-FW-T - Metal angle bracket, including M20 cable gland



171455 SL7/4-FW-T

[Overview](#) [Specifications](#) [Resources](#)



171455 SL7/4-FW-T

Metal angle bracket, including M20 cable gland

Alternate Catalog No.

EL-Nummer (Norway)

Metal mounting bracket, including M20 cable gland

SL7/4-FW-T

4137710

• [Delivery program](#)

• [Design verification as per IEC/EN 61439](#)

• [Technical data ETIM 7.0](#)

• [Approvals](#)

• [Dimensions](#)

Delivery program

Product range

Accessories

Basic function accessories

Including mounting bracket M20 cable gland

Material

Stainless steel (angle)

Aluminium (Gewindeadapter)

Mounting type

for vertical mounting

Gasket included as standard

For use with

SL4-PIB-T...

SL7-CB-T...

Connection to SmartWire-DT

no

Design verification as per IEC/EN 61439

Operating ambient temperature min.

-30 °C

Operating ambient temperature max.

+60 °C

Technical data ETIM 7.0

Low-voltage industrial components (EG000017) / Wall bracket for signal tower (EC001153)

Electric engineering, automation, process control engineering / Low-voltage switch technology / Command and alarm device / Signal column element, attaching bracket (ecl@ss10.0.1-27-37-12-33 [AKF051014])

Mounting method

Wall mounting

Colour

Other

[Approvals](#)

Approvals

Product Standards

IEC/EN 60947-5-1; UL 508; CSA-C22.2 No. 14-10; CSA-C22.2 No. 94-91; CE marking

UL File No.

E29184

UL Category Control No.

NKCR

CSA File No.

UL report applies to both US and Canada

CSA Class No.

NKCR7

North America Certification

UL listed, certified by UL for use in Canada

Degree of Protection

UL Type 4, 4X, 13

Dimensions

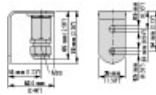

CAD data

- [Product-specific CAD data](#)
(Web)
- [3D Preview](#)
(Web)

DWG files

- [DA-CD-sl74_fw_t](#)
File
(Web)

edz files

- [DA-CE-ETN.SL7_4-FW-T](#)
File
(Web)

Step files

- [DA-CS-sl74_fw_t](#)
File
(Web)

Product photo

- 
[1160PIC-1300](#)
Photo

3D drawing

- 
[1160DRW-310](#)
Line drawing

Dimensions single product

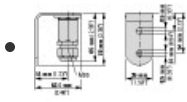

1160DIM-81
Line drawing

Instruction Leaflet

- [Signal Towers SL4/7: Accessories \(IL047006ZU\)](#)
Asset
(PDF, multilingual)

Declaration of Conformity

EU

- [Signal tower series SL4 and SL7 \(DA-DC-00003679\)](#)
Asset
(PDF)

Download-Center

- [Download-Center \(this item\)](#)
Eaton EMEA Download-Center - download data for this item
- [Download-Center](#)
Eaton EMEA Download-Center

 [Generate data sheet in PDF format](#)

 [Generate data sheet in Excel format](#)

 [Write a comment](#)

[Imprint](#) [Privacy Policy](#) [Legal Disclaimer](#) [Terms and Conditions](#)

© 2021 by Eaton Industries GmbH