

Select your language

- German
- English
- Spanish
- French
- Dutch
- Italian
- Polish
- Czech
- Russian
- Norwegian Bokmål

Worldwide English



DILMT32(230V50HZ/240V60HZ) - Contactor, 3 pole, 380 V 400 V: 15 kW, 230 V 50 Hz, 240 V 60 Hz, AC operation, Screw terminals



190999 DILMT32(230V50HZ/240V60HZ)

[Overview](#) [Specifications](#) [Resources](#)



190999 DILMT32(230V50HZ/240V60HZ)

Contactor, 3 pole, 380 V 400 V: 15 kW, 230 V 50 Hz, 240 V 60 Hz, AC operation, Screw terminals
EL-Nummer (Norway) 4100440

Contactor, Application: Contactors for Motors, Contactors up to 95 A, 3 pole, Utilization category: AC-1: Non-inductive or slightly inductive loads, resistance furnaces, NAC-3: Normal AC induction motors: starting, switch off during running, AC-4: Normal AC induction motors: starting, plugging, reversing, inching, Connection technique: Screw terminals, Notes: Also suitable for motors with efficiency class IE3., Number of poles: 3 pole, Rated operational current AC-3 380 V 400 V: $I_e = 32$ A, Rated operational current AC-1 Conventional free air thermal current, 3 pole, 50 - 60 Hz Open at 40 °C: $I_{th} = I_e = 40$ A, Max. rating for three-phase motors, 50 - 60 Hz AC-3 220 V 230 V: P= 10 kW, 380 V 400 V: P= 15 kW, Can be combined with auxiliary contact: DILT-XH101(10), Voltage AC/DC: AC operation

- Delivery program
- Technical data
- Design verification as per IEC/EN 61439
- Technical data ETIM 7.0
- Approvals
- Dimensions

Delivery program

Product range

Contactors

Application

Contactors for Motors

Subrange

Contactors up to 95 A, 3 pole

Utilization category

AC-1: Non-inductive or slightly inductive loads, resistance furnaces

AC-3/AC-3e: Normal AC induction motors: Starting, switching off while running

AC-4: Normal AC induction motors: starting, plugging, reversing, inching

Notes

Also suitable for motors with efficiency class IE3.

Connection technique

Screw terminals

Number of poles

3 pole

Rated operational current

AC-3Notes

Also tested according to AC-3e.

AC-3380 V 400 V [I_e]

32 A

AC-1Conventional free air thermal current, 3 pole, 50 - 60 HzOpenat 40 °C [$I_{th} = I_e$]

40 A

Max. rating for three-phase motors, 50 - 60 Hz

AC-3220 V 230 V [P]

10 kW
AC-3380 V 400 V [F]
15 kW
Contact sequence

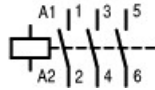

Can be combined with auxiliary contact
DILT-XH101(10)
Actuating voltage
230 V 50 Hz, 240 V 60 Hz
Voltage AC/DC
AC operation
Connection to SmartWire-DT
no
Frame size
2

Technical data

General

Standards

IEC/EN 60947, GB14048, EN60335-1

Lifespan, mechanicalAC operated [Operations]

10 x 10⁶

AC-3 [Operations]

1 x 10⁶

AC-4 [Operations]

0.1 x 10⁶

Operating frequency, mechanicalAC operated [Operations/h]

3600

Climatic proofing

Damp heat, constant, to IEC 60068-2-78

Damp heat, cyclic, to IEC 60068-2-30

Ambient temperatureOpen

-25 - +55 °C

Ambient temperatureStorage

- 40 - 80 °C

Mounting position

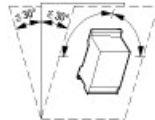

Degree of Protection

IP20

WeightAC operated

0.36 kg

Screw connector terminalsTerminal capacity main cableSolid

1 x (1 - 10)

2 x (1 - 6) mm²

Screw connector terminalsTerminal capacity main cableStranded

1 x (1 - 10)

2 x (1 - 10) mm²

Screw connector terminalsTerminal capacity main cableStripping length

14 mm

Screw connector terminalsTerminal capacity main cableTerminal screw

M5

Screw connector terminalsTerminal capacity main cableTightening torque

2 Nm

Screw connector terminalsTerminal capacity main cableToolPozidriv screw driver

2 Size

Screw connector terminalsTerminal capacity control circuit cablesSolid

1 x (0.75 - 2.5)

2 x (0.75 - 2.5) mm²

Screw connector terminalsTerminal capacity control circuit cablesTerminal screw

M3.5

Screw connector terminalsTerminal capacity control circuit cablesTightening torque

0.8 Nm

Screw connector terminalsTerminal capacity control circuit cablesToolPozidriv screw driver

2 Size

Main conducting paths
 Rated impulse withstand voltage [U_{imp}]
 6000 V AC
 Overvoltage category/pollution degree
 III/3
 Rated insulation voltage [U_i]
 690 V AC
 Rated operational voltage [U_e]
 660 V AC
 Breaking capacity 380 V 400 V
 256 A
 AC
 AC-1 Rated operational current Conventional free air thermal current, 3 pole, 50 - 60 Hz Operat 40 °C [$I_{th} = I_e$]
 40 A
 AC-3 Rated operational current Open, 3-pole: 50 – 60 Hz Notes
 Also tested according to AC-3e.
 AC-3 Rated operational current Open, 3-pole: 50 – 60 Hz 220 V 230 V [I_e]
 32 A
 AC-3 Rated operational current Open, 3-pole: 50 – 60 Hz 240 V [I_e]
 32 A
 AC-3 Rated operational current Open, 3-pole: 50 – 60 Hz 380 V 400 V [I_e]
 32 A
 AC-3 Mtor rating [P] 220 V 230 V [P]
 10 kW
 AC-3 Mtor rating [P] 380 V 400 V [P]
 15 kW
 Magnet systems
 Voltage tolerance AC operated [Pick-up]
 0.85 - 1.1 x U_c
 Power consumption of the coil in a cold state and 1.0 x U_s 50 Hz [Pick-up]
 85 VA
 Power consumption of the coil in a cold state and 1.0 x U_s 50 Hz [Sealing]
 8.5 VA
 Power consumption of the coil in a cold state and 1.0 x U_s 50 Hz [Sealing]
 2.6 W
 Power consumption of the coil in a cold state and 1.0 x U_s 60 Hz [Pick-up]
 80 VA
 Power consumption of the coil in a cold state and 1.0 x U_s 60 Hz [Sealing]
 8.1 VA
 Power consumption of the coil in a cold state and 1.0 x U_s 60 Hz [Sealing]
 2.5 W
 Power consumption of the coil in a cold state and 1.0 x U_s 50/60 Hz [Pick-up]
 0
 VA
 Power consumption of the coil in a cold state and 1.0 x U_s 50/60 Hz [Sealing]
 0
 VA
 Power consumption of the coil in a cold state and 1.0 x U_s 50/60 Hz [Sealing]
 0
 W

Design verification as per IEC/EN 61439

Operating ambient temperature min.
 -25 °C
 Operating ambient temperature max.
 +55 °C

Technical data ETIM 7.0

Low-voltage industrial components (EG000017) / Power contactor, AC switching (EC000066)
 Electric engineering, automation, process control engineering / Low-voltage switch technology / Contactor (LV) /
 Power contactor, AC switching (ec1@ss10.0.1-27-37-10-03 [AAB718015])
 Rated control supply voltage U_s at AC 50HZ
 230 - 230 V
 Rated control supply voltage U_s at AC 60HZ
 240 - 240 V
 Rated control supply voltage U_s at DC
 0 - 0 V

Voltage type for actuating
 AC
 Rated operation current I_e at AC-1, 400 V
 40 A
 Rated operation current I_e at AC-3, 400 V
 32 A
 Rated operation power at AC-3, 400 V
 15 kW
 Rated operation current I_e at AC-4, 400 V
 0 A
 Rated operation power at AC-4, 400 V
 0 kW
 Rated operation power NEMA
 0 kW
 Modular version
 No
 Number of auxiliary contacts as normally open contact
 0
 Number of auxiliary contacts as normally closed contact
 0
 Type of electrical connection of main circuit
 Screw connection
 Number of normally closed contacts as main contact
 0
 Number of main contacts as normally open contact
 3

Approvals

Specially designed for North America
 No

Dimensions

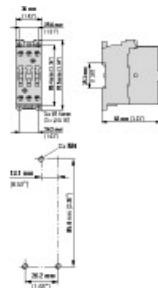

Product photo



2100PIC-249
 Photo

Wiring diagram



210S045
 Line drawing
 Contacts

Dimensions single product

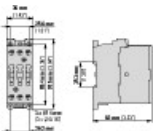

2100DIM-54
Line drawing



2100DIM-58
Line drawing

3D drawing

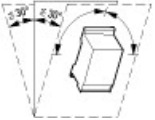

0001052
Line drawing
Mounting position, contactor

2100DRW-435
Line drawing

Declaration of Conformity

EU

- [Eaton-AC Contactors; Control Relay; Auxiliary Contact \(DA-DC-00003681\)](#)
Asset
(PDF)

Instruction Leaflet

- [Contactor relays and contactors up to 32 A \(IL034050ZU\)](#)
Asset
Internal packing pressure for contactors up to 32 A
(PDF, 06/2018, multilingual)

CAD data

edz files

- [DA-CE-ETN.DILMT32\(230V50HZ_240V60HZ\)](#)
File
(Web)

Download-Center

- [Download-Center \(this item\)](#)
Eaton EMEA Download-Center - download data for this item
- [Download-Center](#)
Eaton EMEA Download-Center

[Generate data sheet in PDF format](#)

[Generate data sheet in Excel format](#)

[Write a comment](#)

[Imprint](#) [Privacy Policy](#) [Legal Disclaimer](#) [Terms and Conditions](#)

© 2021 by Eaton Industries GmbH