

Select your language

- German
- English
- French
- Dutch
- Italian
- Polish
- Czech
- Russian
- Norwegian Bokmål

Worldwide English



Powering Business Worldwide

DILMT17(230V50HZ/240V60HZ) - Contactor, 3 pole, 380 V 400 V: 7.5 kW, 230 V 50 Hz, 240 V 60 Hz, AC operation, Screw terminals



190997 DILMT17(230V50HZ/240V60HZ)

[Overview](#) [Specifications](#) [Resources](#)



# 190997

## DILMT17(230V50HZ/240V60HZ)

Contactor, 3 pole, 380 V 400 V: 7.5 kW, 230 V 50 Hz, 240 V 60 Hz, AC operation, Screw terminals  
Contactor, Application: Contactors for Motors, Contactors up to 95 A, 3 pole, Utilization category: AC-1: Non-inductive or slightly inductive loads, resistance furnaces, NAC-3: Normal AC induction motors: starting, switch off during running, AC-4: Normal AC induction motors: starting, plugging, reversing, inching, Connection technique: Screw terminals, Notes: Not suitable for motors with efficiency class IE3., Number of poles: 3 pole, Rated operational current AC-3 380 V 400 V:  $I_e = 17$  A, Rated operational current AC-1 Conventional free air thermal current, 3 pole, 50 - 60 Hz Open at 40 °C:  $I_{th} = I_e = 25$  A, Max. rating for three-phase motors, 50 - 60 Hz AC-3 220 V 230 V:  $P = 5$  kW, 380 V 400 V:  $P = 7.5$  kW, Can be combined with auxiliary contact: DILT-XH101(10), Voltage AC/DC: AC operation

- [Delivery program](#)
- [Technical data](#)
- [Design verification as per IEC/EN 61439](#)
- [Technical data ETIM 7.0](#)
- [Approvals](#)
- [Dimensions](#)

## Delivery program

Product range

Contactors

Application

Contactors for Motors

Subrange

Contactors up to 95 A, 3 pole

Utilization category

AC-1: Non-inductive or slightly inductive loads, resistance furnaces

AC-3/AC-3e: Normal AC induction motors: Starting, switching off while running

AC-4: Normal AC induction motors: starting, plugging, reversing, inching

Notes

Also suitable for motors with efficiency class IE3.

Connection technique

Screw terminals

Number of poles

3 pole

Rated operational current

AC-3Notes

Also tested according to AC-3e.

AC-3380 V 400 V [ $I_e$ ]

17 A

AC-1Conventional free air thermal current, 3 pole, 50 - 60 HzOpen at 40 °C [ $I_{th} = I_e$ ]

25 A

Max. rating for three-phase motors, 50 - 60 Hz

AC-3220 V 230 V [P]

5 kW

AC-3380 V 400 V [P]

7.5 kW

Contact sequence

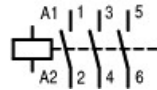

Can be combined with auxiliary contact

DILT-XH01(10)

Actuating voltage

230 V 50 Hz, 240 V 60 Hz

Voltage AC/DC

AC operation

Connection to SmartWire-DT

no

Frame size

2

## Technical data

General

Standards

IEC/EN 60947, GB14048

Lifespan, mechanicalAC operated [Operations]

$10 \times 10^6$

Operating frequency, mechanicalAC operated [Operations/h]

3600

Climatic proofing

Damp heat, constant, to IEC 60068-2-78

Damp heat, cyclic, to IEC 60068-2-30

Ambient temperatureOpen

-25 - +55 °C

Ambient temperatureStorage

-40 - 80 °C

Mounting position

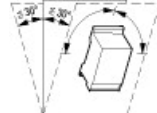

Degree of Protection

IP20

WeightAC operated

0.36 kg

Screw connector terminalsTerminal capacity main cableSolid

1 x (1 - 10)

2 x (1 - 6) mm<sup>2</sup>

Screw connector terminalsTerminal capacity main cableStranded

1 x (1 - 4)

2 x (1 - 4) mm<sup>2</sup>

Screw connector terminalsTerminal capacity main cableStripping length

14 mm

Screw connector terminalsTerminal capacity main cableTerminal screw

M5

Screw connector terminalsTerminal capacity main cableTightening torque

2 Nm

Screw connector terminalsTerminal capacity main cableToolPozidriv screw driver

2 Size

Screw connector terminalsTerminal capacity control circuit cablesSolid

1 x (0.75 - 2.5)

2 x (0.75 - 2.5) mm<sup>2</sup>

Screw connector terminalsTerminal capacity control circuit cablesTerminal screw

M3.5

Screw connector terminalsTerminal capacity control circuit cablesTightening torque

0.8 Nm

Screw connector terminalsTerminal capacity control circuit cablesToolPozidriv screw driver

2 Size

Main conducting paths

Rated impulse withstand voltage [U<sub>imp</sub>]

6000 V AC

Overvoltage category/pollution degree  
 III/3  
 Rated insulation voltage [U]  
 690 V AC  
 Rated operational voltage [U<sub>e</sub>]  
 660 V AC  
 Breaking capacity 380 V 400 V  
 144 A  
 AC  
 AC-1 Rated operational current Conventional free air thermal current, 3 pole, 50 - 60 Hz Operat 40 °C [I<sub>th</sub>=I<sub>e</sub>]  
 25 A  
 AC-3 Rated operational current Open, 3-pole: 50 – 60 Hz Notes  
 Also tested according to AC-3e.  
 AC-3 Rated operational current Open, 3-pole: 50 – 60 Hz 220 V 230 V [I<sub>e</sub>]  
 17 A  
 AC-3 Rated operational current Open, 3-pole: 50 – 60 Hz 240 V [I<sub>e</sub>]  
 17 A  
 AC-3 Rated operational current Open, 3-pole: 50 – 60 Hz 380 V 400 V [I<sub>e</sub>]  
 17 A  
 AC-3 Rated operational current Open, 3-pole: 50 – 60 Hz 380 V 400 V [I<sub>e</sub>]  
 17 A  
 AC-3 Motor rating [P] 220 V 230 V [P]  
 5 kW  
 AC-3 Motor rating [P] 380 V 400 V [P]  
 7.5 kW  
 Magnet systems  
 Voltage tolerance AC operated [Pick-up]  
 0.85 - 1.1 x U<sub>c</sub>  
 Power consumption of the coil in a cold state and 1.0 x U<sub>s</sub> 50 Hz [Pick-up]  
 85 VA  
 Power consumption of the coil in a cold state and 1.0 x U<sub>s</sub> 50 Hz [Sealing]  
 8.5 VA  
 Power consumption of the coil in a cold state and 1.0 x U<sub>s</sub> 50 Hz [Sealing]  
 2.6 W  
 Power consumption of the coil in a cold state and 1.0 x U<sub>s</sub> 60 Hz [Pick-up]  
 80 VA  
 Power consumption of the coil in a cold state and 1.0 x U<sub>s</sub> 60 Hz [Sealing]  
 8.1 VA  
 Power consumption of the coil in a cold state and 1.0 x U<sub>s</sub> 60 Hz [Sealing]  
 2.5 W  
 Power consumption of the coil in a cold state and 1.0 x U<sub>s</sub> 50/60 Hz [Pick-up]  
 0  
 VA  
 Power consumption of the coil in a cold state and 1.0 x U<sub>s</sub> 50/60 Hz [Sealing]  
 0  
 VA  
 Power consumption of the coil in a cold state and 1.0 x U<sub>s</sub> 50/60 Hz [Sealing]  
 0  
 W

## Design verification as per IEC/EN 61439

Operating ambient temperature min.  
 -25 °C  
 Operating ambient temperature max.  
 +55 °C

## Technical data ETIM 7.0

Low-voltage industrial components (EG000017) / Power contactor, AC switching (EC000066)  
 Electric engineering, automation, process control engineering / Low-voltage switch technology / Contactor (LV) /  
 Power contactor, AC switching (ec1@ss10.0.1-27-37-10-03 [AAB718015])  
 Rated control supply voltage U<sub>s</sub> at AC 50 Hz  
 230 - 230 V  
 Rated control supply voltage U<sub>s</sub> at AC 60 Hz  
 240 - 240 V  
 Rated control supply voltage U<sub>s</sub> at DC  
 0 - 0 V  
 Voltage type for actuating  
 AC

Rated operation current  $I_e$  at AC-1, 400 V  
25 A  
 Rated operation current  $I_e$  at AC-3, 400 V  
17 A  
 Rated operation power at AC-3, 400 V  
7.5 kW  
 Rated operation current  $I_e$  at AC-4, 400 V  
0 A  
 Rated operation power at AC-4, 400 V  
0 kW  
 Rated operation power NEMA  
0 kW  
 Modular version  
No  
 Number of auxiliary contacts as normally open contact  
0  
 Number of auxiliary contacts as normally closed contact  
0  
 Type of electrical connection of main circuit  
Screw connection  
 Number of normally closed contacts as main contact  
0  
 Number of main contacts as normally open contact  
3

## Approvals

Specially designed for North America  
No

## Dimensions

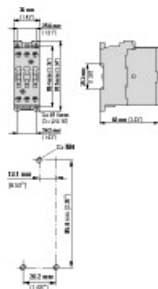

## Product photo



Photo  
Product photo  
Photo

## Wiring diagram



Contact sequence  
Wiring diagram  
Line drawing  
Contacts

## Dimensions single product

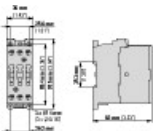

#### 2100DIM-54

Dimensions single product  
Line drawing



#### 2100DIM-58

Dimensions single product  
Line drawing

## 3D drawing

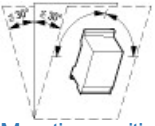

#### Mounting position

3D drawing  
Line drawing  
Mounting position, contactor

#### 2100DRW-435

3D drawing  
Line drawing

## Declaration of Conformity

- [DA-DC-00002909](#)  
Declaration of Conformity  
(PDF)

## CAD data

- [DA-CE-ETN.DILMT17\(230V50HZ\\_240V60HZ\)](#)  
CAD data  
edz files  
(Web)

## Download-Center

- [Download-Center \(this item\)](#)  
Eaton EMEA Download-Center - download data for this item
- [Download-Center](#)  
Eaton EMEA Download-Center



[Generate data sheet in PDF format](#)



[Generate data sheet in Excel format](#)



[Write a comment](#)

[Imprint](#) [Privacy Policy](#) [Legal Disclaimer](#) [Terms and Conditions](#)

© 2020 by Eaton Industries GmbH