

ANAMET FITTINGS (UL/CSA) for Sealtite®

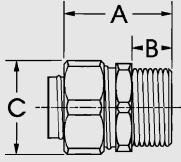

ISO, straight fitting



ISO thread		M12x1,5*	M16X1,5	M20X1,5	M16X1,5	M20X1,5	M25X1,5	M32X1,5	M40X1,5	M50X1,5	M63X1,5
For Sealtite size	inch	1/4"	5/16"	5/16"	3/8"	1/2"	3/4"	1"	1.1/4"	1.1/2"	2"
Min. inside diameter	mm	5,6	9,0	9,0	10,4	13,7	18,8	23,8	31,6	36,8	48,0
Dimensions in mm	A	30	39	40	37	37	38	41	51	57	64
	B	10	17	18	16	16	16	19	16	16	18
	C	22	21	21	26	29	35	42	56	65	76
Standard carton	pcs.	25	25	25	25	25	25	10	5	2	1
Article no.		295.007.0	295.009.0	295.010.0	295.012.0	295.016.0	295.020.0	295.026.0	295.035.0	295.040.0	295.050.0

Fittings 1/4" and 5/16" without approvals



ISO, 45° fitting

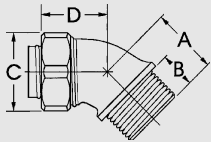

ISO thread		M16X1,5	M20X1,5	M25X1,5	M32X1,5	M40x1,5
For Sealtite size	inch	3/8"	1/2"	3/4"	1"	1.1/4"
Min. inside diameter	mm	10,4	13,7	18,8	23,8	31,6
Dimensions in mm	A	22	22	29	35	40
	B	16	16	16	19	19
	C	26	29	35	42	55
	D	22	22	29	35	48
Standard carton	pcs.	25	25	10	5	5
Article no.		295.412.0	295.416.0	295.420.0	295.426.0	295.435.0



ISO, 90° fitting

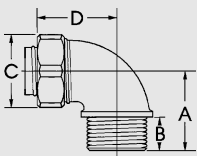

ISO thread		M16X1,5	M20X1,5	M25X1,5	M32X1,5	M40x1,5
For Sealtite size	inch	3/8"	1/2"	3/4"	1"	1.1/4"
Min. inside diameter	mm	10,4	13,7	18,8	23,8	31,6
Dimensions in mm	A	32	32	37	35	55
	B	16	16	16	19	20
	C	26	29	35	42	55
	D	38	38	40	48	65
Standard carton	pcs.	25	25	10	5	5
Article no.		295.912.0	295.916.0	295.920.0	295.926.0	295.935.0

ISO, 90° elbow*



ISO thread (inside x outside)		M12x1,5	M16x1,5
Standard carton	pcs.	50	50
Article no.		883.120.0	883.160.0

* Elbow 90° can only be used in combination with a straight fitting. (without UL/CSA approval)

ANAMET fittings (UL/CSA) for Sealtite (excl. CNP):

These Anamet fittings have besides several European approvals, also an UL and CSA approval. These easy to install 3-part fittings are IP 67 liquid-tight and made out of galvanised steel. The fittings are available in ISO, PG or NPT thread, in a straight, 45° and 90° model.

Temperature -55°C till 250°C.

UL SP D N S PG, straight fitting

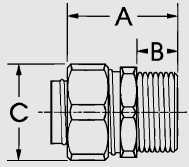

PG thread		7*	9*	11	13,5	16	21	29	36	42	48
For Sealtite size	inch	1/4"	5/16"	3/8"	3/8"	1/2"	3/4"	1"	1.1/4"	1.1/2"	2"
Min. inside diameter	mm	5,6	9,0	10,4	10,4	13,7	18,8	23,8	31,6	36,8	48,0
Dimensions in mm	A	23	28	37	37	37	38	41	51	57	64
	B	6	7	16	16	16	16	19	16	16	18
	C	19	21	26	26	29	35	42	56	65	76
Standard carton	pcs.	25	25	25	25	25	25	5	5	2	1
Article no.		883.007.0	883.009.0	299.011.0	299.013.0	299.016.0	299.020.0	299.026.0	299.035.0	299.040.0	299.050.0

* PG 7 & 9 without approvals

UL SP D N S PG, 45° fitting

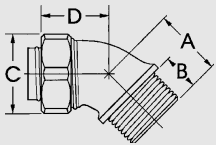

PG thread		11	13,5	16	21	29	36	42	48
Voor Sealtite maat	inch	3/8"	3/8"	1/2"	3/4"	1"	1.1/4"	1.1/2"	2"
Min. inside diameter	mm	10,4	10,4	13,7	18,8	23,8	31,6	36,8	48,0
Dimensions in mm	A	22	22	22	29	35	41	46	51
	B	16	16	16	16	19	16	16	18
	C	26	26	29	35	42	56	65	76
	D	22	22	22	29	35	41	46	51
Standard carton	pcs.	25	25	25	10	5	5	2	1
Article no.		299.411.0	299.413.0	299.416.0	299.420.0	299.426.0	299.435.0	299.440.0	299.450.0

UL SP D N S PG, 90° fitting

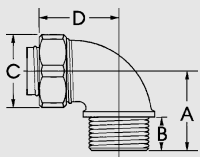

PG thread		11	13,5	16	21	29	36	42	48
For PG size	inch	3/8"	3/8"	1/2"	3/4"	1"	1.1/4"	1.1/2"	2"
Min. inside diameter	mm	10,4	10,4	13,7	18,8	23,8	31,6	36,8	48,0
Dimensions in mm	A	32	32	32	37	35	46	62	69
	B	16	16	16	16	19	16	16	18
	C	26	26	29	35	42	56	65	76
	D	38	38	38	40	48	61	81	91
Standard carton	pcs.	25	25	25	10	5	5	2	1
Article no.		299.911.0	299.913.0	299.916.0	299.920.0	299.926.0	299.935.0	299.940.0	299.950.0

PG, 90° elbow*



PG thread (inside x outside)		7	9
Standard carton	pcs.	100	100
Article no.		883.107.0	883.109.0

* Elbow 90° can only be used in combination with a straight fitting. (without UL / CSA) approval

ANAMET FITTINGS (UL/CSA) for Sealtite®

UL SP D N S SETI NPT, straight fitting (incl. locknut)

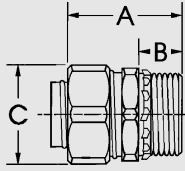

NPT thread		1/2"	1/2"	3/4"	1"	1.1/4"	1.1/2"	2"	2.1/2"	3"	4"
For Sealtite size	inch	3/8"	1/2"	3/4"	1"	1.1/4"	1.1/2"	2"	2.1/2"	3"	4"
Min. inside diameter	mm	10,4	13,7	18,8	23,8	31,6	36,8	48,0	58,5	-	-
Dimensions in mm	A	37	37	38	41	51	57	64	86	94	102
	B	16	16	16	19	16	16	18	27	30	32
	C	26	29	35	42	56	65	76	92	108	133
Standard carton	pcs.	25	25	25	5	5	2	1	1	1	1
Article no.		298.012.0	298.016.0	298.020.0	298.026.0	298.035.0	298.040.0	298.050.0	298.063.0	298.075.0	298.099.0

NPT 2.1/2" to 4" without NEMKO, DEMKO, SEMKO & SETI approval. On request available in aluminium.

UL SP D N S SETI NPT, 45° fitting (incl. locknut)

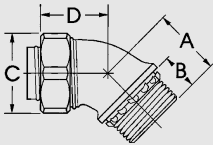

NPT thread		1/2"	1/2"	3/4"	1"	1.1/4"	1.1/2"	2"	2.1/2"	3"	4"
For Sealtite size	inch	3/8"	1/2"	3/4"	1"	1.1/4"	1.1/2"	2"	2.1/2"	3"	4"
Min. inside diameter	mm	10,4	13,7	18,8	23,8	31,6	36,8	48,0	58,5	-	-
Dimensions in mm	A	22	22	29	35	41	46	51	91	110	118
	B	16	16	16	19	16	16	18	27	30	32
	C	26	29	35	42	56	65	76	92	108	133
	D	22	22	29	35	41	46	51	91	110	118
Standard carton	pcs.	25	25	25	5	5	2	1	1	1	1
Article no.		298.412.0	298.416.0	298.420.0	298.426.0	298.435.0	298.440.0	298.450.0	298.463.0	298.475.0	298.499.0

NPT 2.1/2" to 4" without NEMKO, DEMKO, SEMKO & SETI approval.

UL SP D N S SETI NPT, 90° fitting (incl. locknut)

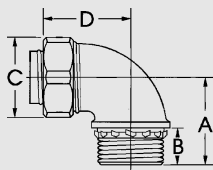

NPT thread		1/2"	1/2"	3/4"	1"	1.1/4"	1.1/2"	2"	2.1/2"	3"	4"
For Sealtite size	inch	3/8"	1/2"	3/4"	1"	1.1/4"	1.1/2"	2"	2.1/2"	3"	4"
Min. inside diameter	mm	10,4	13,7	18,8	23,8	31,6	36,8	48,0	58,5	-	-
Dimensions in mm	A	32	32	37	35	46	62	67	183	220	287
	B	16	16	16	19	16	16	18	27	30	32
	C	26	29	35	42	56	65	76	92	108	133
	D	38	38	40	48	61	81	91	215	258	327
Standard carton	pcs.	25	25	10	5	5	2	1	1	1	1
Article no.		298.912.0	298.916.0	298.920.0	298.926.0	298.935.0	298.940.0	298.950.0	298.963.0	298.975.0	298.999.0

NPT 2.1/2" to 4" without NEMKO, DEMKO, SEMKO & SETI approval. On request available in aluminium.



NPT, straight female fitting

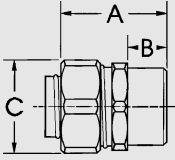

NPT thread		1/2"	1/2"	3/4"	1"
For Sealtite size	inch	3/8"	1/2"	3/4"	1"
Min. inside diameter	mm	10,4	13,7	18,8	23,8
Dimensions in mm	A	33	33	37	40
	B	11	11	13	18
	C	26	29	35	42
Standard carton	pcs.	25	25	25	5
Article no.		298.612.0	298.616.0	298.620.0	298.626.0



STN fitting (without thread)

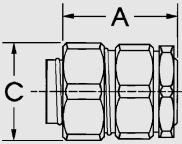

For hole min/max	mm	22/25	22/25	28/31	34/37	43/47	49/53	61/66
For Sealtite size	inch	3/8"	1/2"	3/4"	1"	1.1/4"	1.1/2"	2"
Min. inside diameter	mm	10,4	13,7	18,8	23,8	31,6	36,8	48,0
Dimensions in mm	A	37	37	40	45	67	67	59
	C	26	29	35	42	56	65	76
Standard carton	pcs.	25	25	25	5	5	2	1
Article no.		298.212.0	298.216.0	298.220.0	298.226.0	298.235.0	298.240.0	298.250.0



90° STN fitting (without thread)

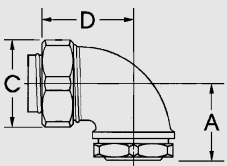

For hole min/max	mm	22/25	22/25	28/31	34/37
For Sealtite size	inch	3/8"	1/2"	3/4"	1"
Min. inside diameter	mm	10,4	13,7	18,8	23,8
Dimensions in mm	C	26	29	35	42
Standard carton	pcs.	25	25	10	5
Article no.		298.812.0	298.816.0	298.820.0	298.826.0

ANAMET STAINLESS STEEL FITTINGS for Sealtite®

ISO, straight stainless steel fitting (AISI 303)

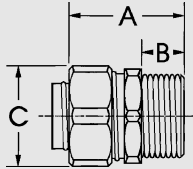

ISO thread		M16X1,5	M20X1,5	M25X1,5	M32X1,5
For Sealtite size	inch	3/8"	1/2"	3/4"	1"
Min. inside diameter	mm	10,4	13,7	18,8	23,8
Dimensions in mm	A	37	37	38	41
	B	15	15	15	18
	C	27	32	36	46
Standard carton	pcs.	50	50	50	50
Article no.		295.012.9	295.016.9	295.020.9	295.026.9

Grounding ferrule in steel.

ISO, straight stainless steel fitting (AISI 316)

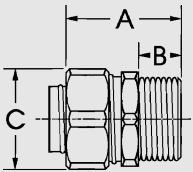

ISO thread		M16X1,5	M20X1,5	M25X1,5	M32X1,5
For Sealtite size	inch	3/8"	1/2"	3/4"	1"
Min. inside diameter	mm	10,4	13,7	18,8	23,8
Dimensions in mm	A	37	37	38	41
	B	15	15	15	18
	C	27	32	36	46
Standard carton	pcs.	50	50	50	50
Article no.		295.112.9	295.116.9	295.120.9	295.126.9

Grounding ferrule in steel.

PG, straight stainless steel fitting (AISI 303)

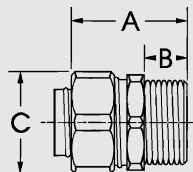

PG thread		11	13,5	16	21	29	36	42	48
For Sealtite size	inch	3/8"	3/8"	1/2"	3/4"	1"	1.1/4"	1.1/2"	2"
Min. inside diameter	mm	10,4	10,4	13,7	18,8	23,8	31,6	36,8	48,0
Dimensions in mm	A	37	37	37	38	41	51	57	64
	B	15	15	15	15	18	19	19	19
	C	27	27	32	36	46	60	70	80
Standard carton	pcs.	50	50	50	50	50	50	25	25
Article no.		299.011.9	299.013.9	299.016.9	299.020.9	299.026.9	299.035.9	299.040.9	299.050.9

Grounding ferrule in steel.

PG, straight stainless steel fitting (AISI 316)

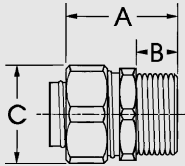

PG thread		11	13,5	16	21	29	36	42	48
For Sealtite size	inch	3/8"	3/8"	1/2"	3/4"	1"	1.1/4"	1.1/2"	2"
Min. inside diameter	mm	10,4	10,4	13,7	18,8	23,8	31,6	36,8	48,0
Dimensions in mm	A	37	37	37	38	41	51	57	64
	B	15	15	15	15	18	19	19	19
	C	27	27	32	36	46	60	70	80
Standard carton	pcs.	50	50	50	50	50	50	25	25
Article no.		299.111.9	299.113.9	299.116.9	299.120.9	299.126.9	299.135.9	299.140.9	299.150.9

Grounding ferrule in steel.

NPT, straight stainless steel fitting (AISI 303)

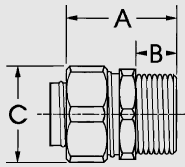

NPT thread		1/2"	1/2"	3/4"	1"	1.1/4"	1.1/2"	2"
For Sealtite size	inch	3/8"	1/2"	3/4"	1"	1.1/4"	1.1/2"	2"
Min. inside diameter	mm	10,4	13,7	18,8	23,8	31,6	36,8	48,0
Dimensions in mm	A	37	37	38	41	51	57	64
	B	15	15	15	18	19	19	19
	C	27	32	36	46	60	70	80
Standard carton	st.	50	50	50	50	50	25	25
Article no.		298.012.9	298.016.9	298.020.9	298.026.9	298.035.9	298.040.9	298.050.9

Grounding ferrule in steel.

NPT, straight stainless steel fitting (AISI 316)

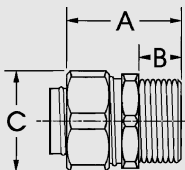

NPT thread		1/2"	1/2"	3/4"	1"	1.1/4"	1.1/2"	2"
For Sealtite size	inch	3/8"	1/2"	3/4"	1"	1.1/4"	1.1/2"	2"
Min. inside diameter	mm	10,4	13,7	18,8	23,8	31,6	36,8	48,0
Dimensions in mm	A	37	37	38	41	51	57	64
	B	15	15	15	18	19	19	19
	C	27	32	36	46	60	70	80
Standard carton	pcs.	50	50	50	50	50	25	25
Article no.		298.112.9	298.116.9	298.120.9	298.126.9	298.135.9	298.140.9	298.150.9

Grounding ferrule in steel.