





CABLE CONNECTOR SIZE S0 SPRING-L.
CONNECTION MULTI-UNIT PACKAGE 10 UNITS



General technical data		
product brandname		SIRIUS
Product designation		connecting plug
Design of the product		for circuit breaker S0 spring-loaded terminal
Size of the circuit-breaker		S0
Installation/ mounting/ dimensions		
Mounting type		clip-on
Certificates/approvals		

General Product Approval	Declaration of Conformity	Test Certificates	Shipping Approval
 CSA	 UL	 EG-Konf.	Declaration of the Compliance with the order  ABS  BUREAU VERITAS

other
Environmental Confirmations

Further information

Information- and Downloadcenter (Catalogs, Brochures,...)

<http://www.siemens.com/industrial-controls/catalogs>

Industry Mall (Online ordering system)

<https://mall.industry.siemens.com/mall/en/en/Catalog/product?mlfb=3RV2927-5A>

Cax online generator

<http://support.automation.siemens.com/WW/CAXorder/default.aspx?lang=en&mlfb=3RV2927-5A>

Service&Support (Manuals, Certificates, Characteristics, FAQs,...)

<https://support.industry.siemens.com/cs/ww/en/ps/3RV2927-5A>

Image database (product images, 2D dimension drawings, 3D models, device circuit diagrams, EPLAN macros, ...)

http://www.automation.siemens.com/bilddb/cax_de.aspx?mlfb=3RV2927-5A&lang=en

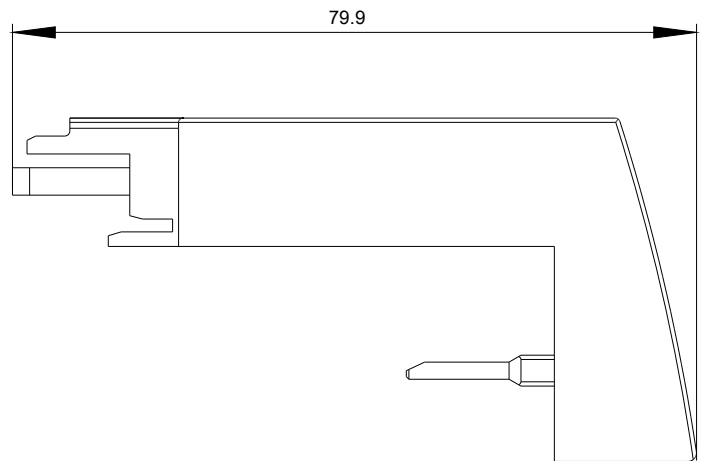
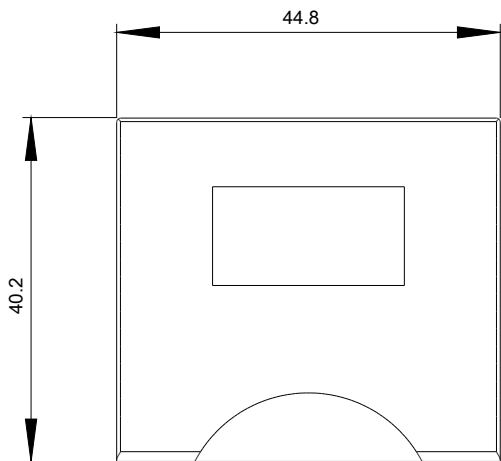

last modified:

05/19/2017