

SURGE SUPPRESSOR, SUPPRESSION DIODE DC
12...250V, F. CONT. RELAYS A. MOTOR CONT. SZ
S00,



General technical data:

product brandname		SIRIUS
Product designation		surge suppressor
Size of contactor		S00
Design of the surge suppressor		with diode
Ambient temperature		
• during storage	°C	-40 ... +80
• during operation	°C	-25 ... +60

Control circuit/ Control:

Type of voltage of the control supply voltage		DC
Control supply voltage 1		
• at DC		
— Initial rated value	V	12
— Final rated value	V	250

Installation/ mounting/ dimensions:

Mounting position		any
Mounting type		clip-on
Width	mm	28

Height	mm	46
Depth	mm	9

Certificates/ approvals:

Certificate of suitability	CE / UL / CSA / CCC
----------------------------	---------------------

General Product Approval	Declaration of Conformity	Test Certificates
--------------------------	---------------------------	-------------------



[Special Test Certificate](#)

[Type Test Certificates/Test Report](#)

Shipping Approval



Shipping Approval	other	Railway
-------------------	-------	---------



[Confirmation](#)

[Environmental Confirmations](#)



[Vibration and Shock](#)

Further information

Information- and Downloadcenter (Catalogs, Brochures,...)

<http://www.siemens.com/industrial-controls/catalogs>

Industry Mall (Online ordering system)

<http://www.siemens.com/industrymall>

Cax online generator

<http://support.automation.siemens.com/WW/CAXorder/default.aspx?lang=en&mlfb=3RT2916-1DG00>

Service&Support (Manuals, Certificates, Characteristics, FAQs,...)

<https://support.industry.siemens.com/cs/ww/en/ps/3RT2916-1DG00>

Image database (product images, 2D dimension drawings, 3D models, device circuit diagrams, EPLAN macros, ...)

http://www.automation.siemens.com/bilddb/cax_de.aspx?mlfb=3RT2916-1DG00&lang=en

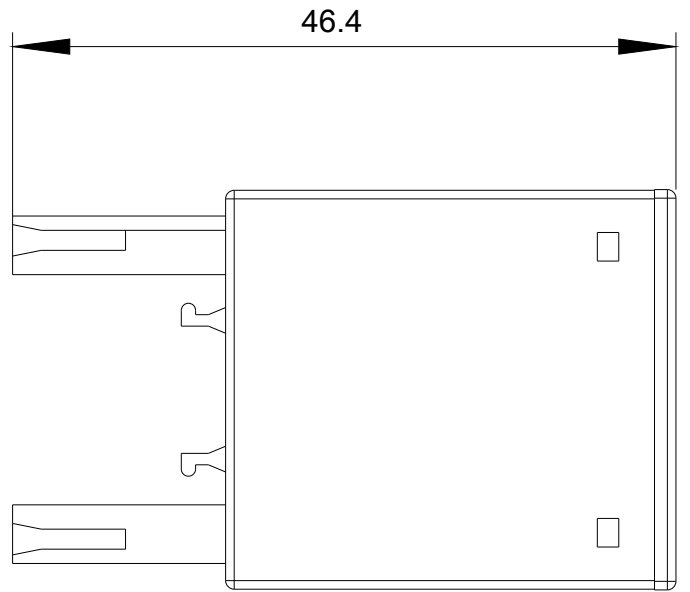
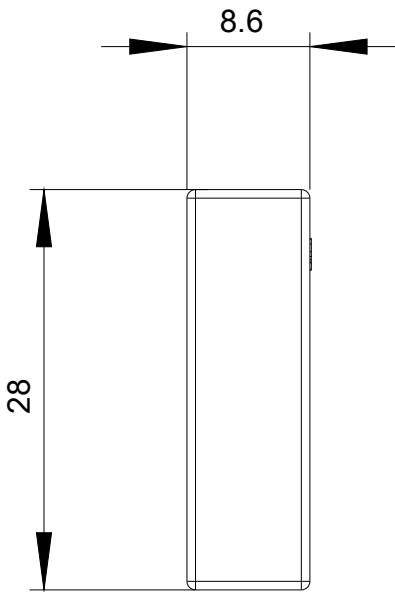

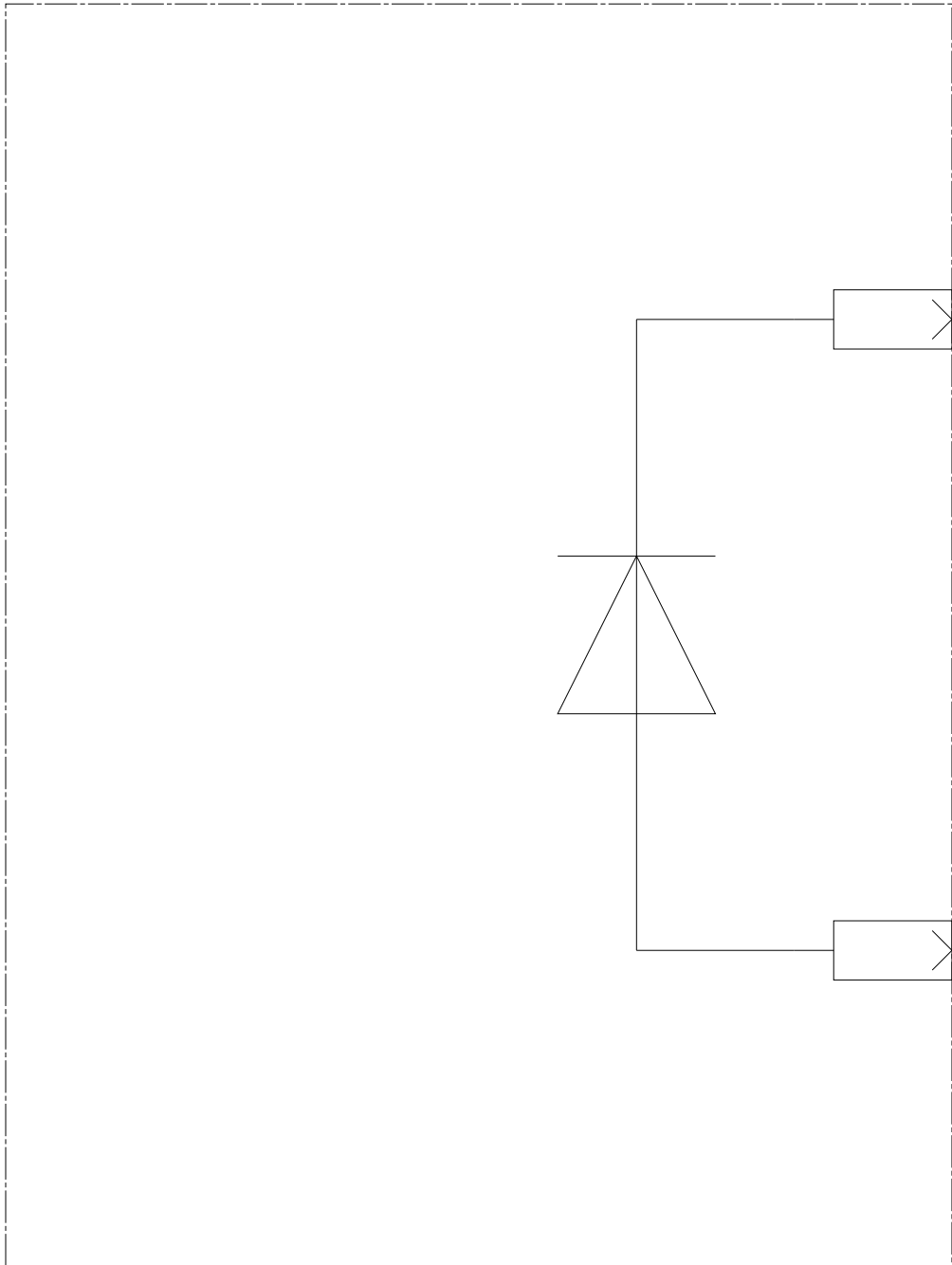

last modified:

06/20/2017