

ADAPTER FOR SCREW MOUNTING



General technical data:







product brandname		SIRIUS
Product designation		adapter for screw fixing
Protection class IP		IP20
Relative humidity during operation	%	10 ... 90
Ambient temperature		
• during transport	°C	-55 ... +80
• during storage	°C	-55 ... +80
• during operation	°C	-20 ... +60
Equipment marking acc. to DIN EN 61346-2		U
Equipment marking acc. to DIN 40719 extended according to IEC 204-2 acc. to IEC 750		U

Installation/ mounting/ dimensions:

Width	mm	26
Height	mm	23
Depth	mm	45

Certificates/ approvals:

Certificate of suitability		IEC / EN 60947-6-2
-----------------------------------	--	--------------------

General Product Approval			EMC	Declaration of Conformity	Shipping Approval
 CSA	 UL		 C-Tick	 EG-Konf.	 BUREAU VERITAS

Shipping Approval					other
 DNV	 LRS	 PRS	 RINA	 RMRS	Environmental Confirmations

other
Confirmation

Further information

Information- and Downloadcenter (Catalogs, Brochures,...)
<http://www.siemens.com/industrial-controls/catalogs>

Industry Mall (Online ordering system)
<http://www.siemens.com/industrymall>

Cax online generator
<http://support.automation.siemens.com/WW/CAXorder/default.aspx?lang=en&mlfb=3RA6940-0A>

Service&Support (Manuals, Certificates, Characteristics, FAQs,...)
<https://support.industry.siemens.com/cs/ww/en/ps/3RA6940-0A>

Image database (product images, 2D dimension drawings, 3D models, device circuit diagrams, EPLAN macros, ...)
http://www.automation.siemens.com/bilddb/cax_de.aspx?mlfb=3RA6940-0A&lang=en

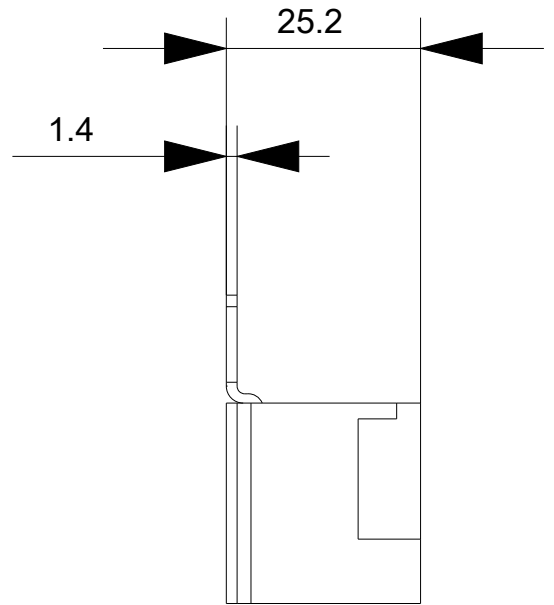
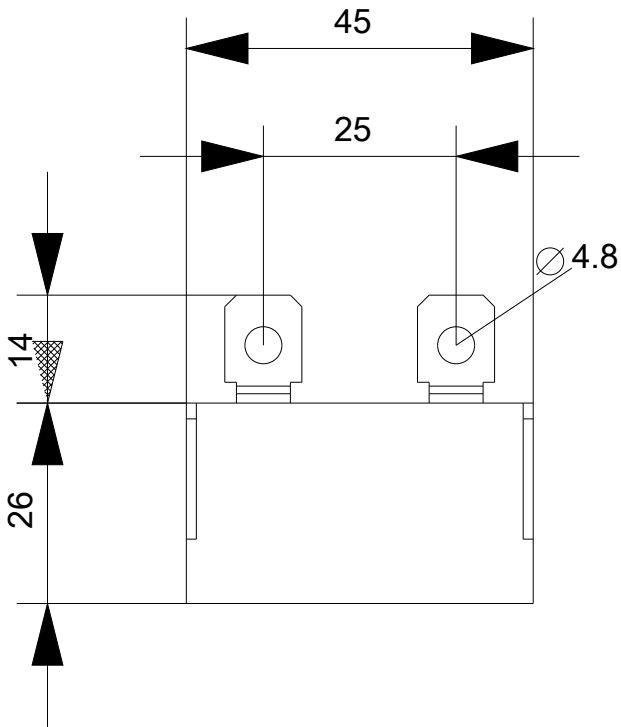

last modified:

07/01/2017