

Low-loss Standard Ballasts 18–58 W, 230 V

For compact fluorescent lamps
Shape: 28x41 mm

Vacuum-impregnated with polyester resin
Push-in terminal for leads: 0.5–1 mm²

For the automatic luminaire wiring:

IDC terminals for leads H05V-U 0.5

tw 130

Protection class I

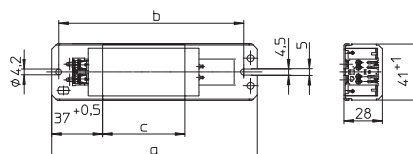
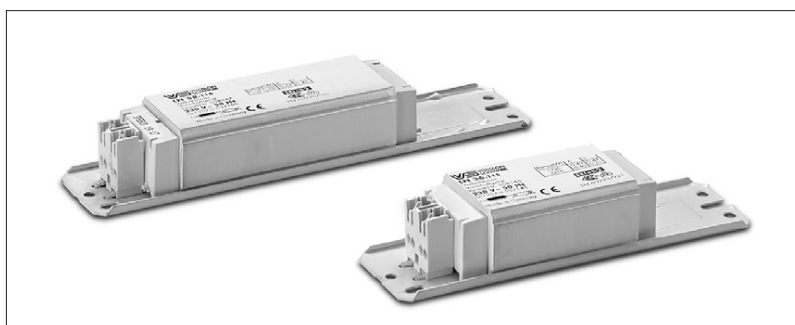

Lamp				Ballast										Capacitor	
Output	Type	Base	Current	Type	Ref. No.	V, Hz	a	b	c	Weight	$\Delta t/\Delta t_{an}$	EEL	C _p	Current	
W			mA				mm	mm	mm	kg	K		μF	mA	
230 V, 50 Hz															
18	TC-D/TC-T	G24d-2/GX24d-2	220	LN 181.319	163763	230, 50	85	75	34	0.32	60/140	B1	2.0	110	
				LN 181.940	508922	230, 50	85	75	34	0.32	50/120	B1	2.0	110	
				LN 181.850	503871	230, 50	85	75	27	0.28	65/165	B2	2.0	110	
18	TC-F/TC-L	2G10/2G11	370	LN 18.510	164572	230, 50	155	140	92	0.80	40/65	B1	4.5	120	
				LN 18.114	508183	230, 50	150	140	60	0.55	55/90	B2	4.5	120	
18	T-U	2G13	370	LN 18.114	508183	230, 50	150	140	60	0.55	55/90	B2	4.5	120	
new >>> 2x18	TC-F/TC-L	2G10/2G11	400	L 36.334	530007	230, 50	150	140	60	0.55	60/155	B1	4.0	210	
				LN 36.115	508185	230, 50	150	140	60	0.55	50/145	B1	4.0	210	
				LN 36.570	169779	230, 50	155	140	92	0.80	35/90	B1	4.0	210	
21	TC-DD	GR10q	260	LN 21.803	169651	230, 50	150	140	53	0.50	45/95	B1	3.0	120	
22	T-R	G10q	400	LN 30.330	169503	230, 50	150	140	67	0.60	55/125	B2	4.5	200	
24	TC-F/TC-L	2G10/2G11	345	LN 24/26.829	179659	230, 50	105	95	53	0.50	60/120	B2	4.5	150	
				LN 24/26.804	169652	230, 50	150	140	60	0.55	55/110	B2	4.5	150	
26	TC-D/TC-T	G24d-3/GX24d-3	325	LN 24/26.829	179659	230, 50	105	95	53	0.50	60/120	B2	3.5	140	
				LN 24/26.804	169652	230, 50	150	140	60	0.55	55/110	B2	3.5	140	
				LN 26.813	509502	230, 50	110	100	45	0.45	55/145	B2	3.5	140	
28	TC-DD	GR8/GR10q	320	LN 18.114	508183	230, 50	150	140	60	0.55	55/90	B1	3.5	150	
				LN 18.510	164572	230, 50	155	140	92	0.80	40/65	B1	3.5	150	
36	TC-F/TC-L	2G10/2G11	430	LN 36.570	169779	230, 50	155	140	92	0.80	35/90	B1	4.5	210	
				LN 36.511	164590	230, 50	155	140	92	0.80	35/95	B1	4.5	210	
				LN 36.115	508185	230, 50	150	140	60	0.55	50/145	B2	4.5	210	
36/40	T-U/TR	2G13/G10q	430	LN 36.570	169779	230, 50	150	140	92	0.80	35/90	B1	4.5	210	
				LN 36.115	508185	230, 50	150	140	60	0.55	50/145	B2	4.5	210	
38	TC-DD	GR10q	430	LN 36.570	169779	230, 50	155	140	92	0.80	35/90	B1	4.5	210	
				LN 36.115	508185	230, 50	150	140	60	0.55	50/145	B2	4.5	210	
58	T-U	2G13	670	LN 58.512	164611	230, 50	233	220	160	1.31	35/85	B1	7.0	320	
				LN 58.568	169389	230, 50	233	220	160	1.31	35/95	B1	7.0	320	
				LN 58.116	508186	230, 50	190	180	92	0.80	55/160	B2	7.0	320	
				LN 58.116	508187	230, 50	233	220	92	0.80	55/160	B2	7.0	320	
				LN 58.990	509349	230, 50	190	180	110	0.95	50/130	B2	7.0	320	
				LN 58.990	509365	230, 50	233	220	110	0.95	50/130	B2	7.0	320	

new >>>

