

## Flow deksel dobbel hvit

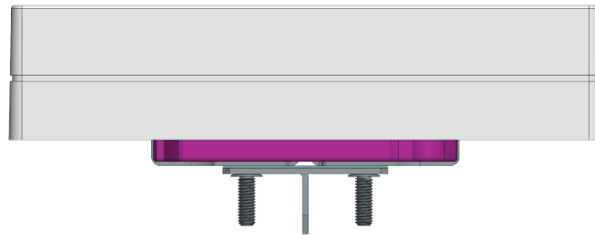

Art.nr.: 121834

EAN nr: 70 900 2646 2046 (10 stk)

Elnr: 15 04 000

### Model: Flow-2CA-W

Double socket cover with shutters, adapter and earth

#### Data for double socket with cover:

Voltage: 16 A + J 250 V AC

IP class: IP 20

Insulation class: 1

Material: V0 flame retardant halogen-free polycarbonate plastic.

C-C distance: 60 mm

Regulations: FEU 2017

Standard: IEC 60884-1:2002,

IEC 60884-1:2002/AMD1:2006,

IEC 60884-1:2002/AMD2:2013.

NEK 502:2016

Country of origin: CN

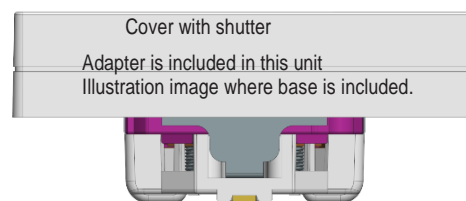

Base for double socket

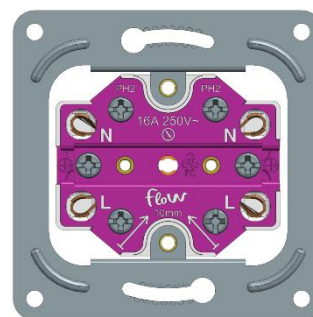

#### Termination:

Screw clamps. 1 or 2 single conductors in the same terminal, alternatively one or 2 multi-wire PN in the same terminal. Single-wire and multi-wire conductors, or conductors with different dimensions, must not be mounted next to others in the same terminal, as the screw and nut will clamp differently against conductors.

Maximum torque: 1.2Nm (According to IEC 62196-1)

Cross section: 1,5 – 2,5 mm<sup>2</sup>

