

# RING 36/600 typ 71204

# ANETA LIGHTING

LIGHTS FOR HOME AND WORK SINCE 1947

SE: Installationen ska utföras av auktoriserad elinstallatör.  
NO: Skal installeres av autorisert elektriker.  
FI: Asennuksen saa tehdä vain valtuutettu sähköasentaja.  
EN: Installation should be performed by a qualified electrician.

www.aneta.no  
www.aneta.se

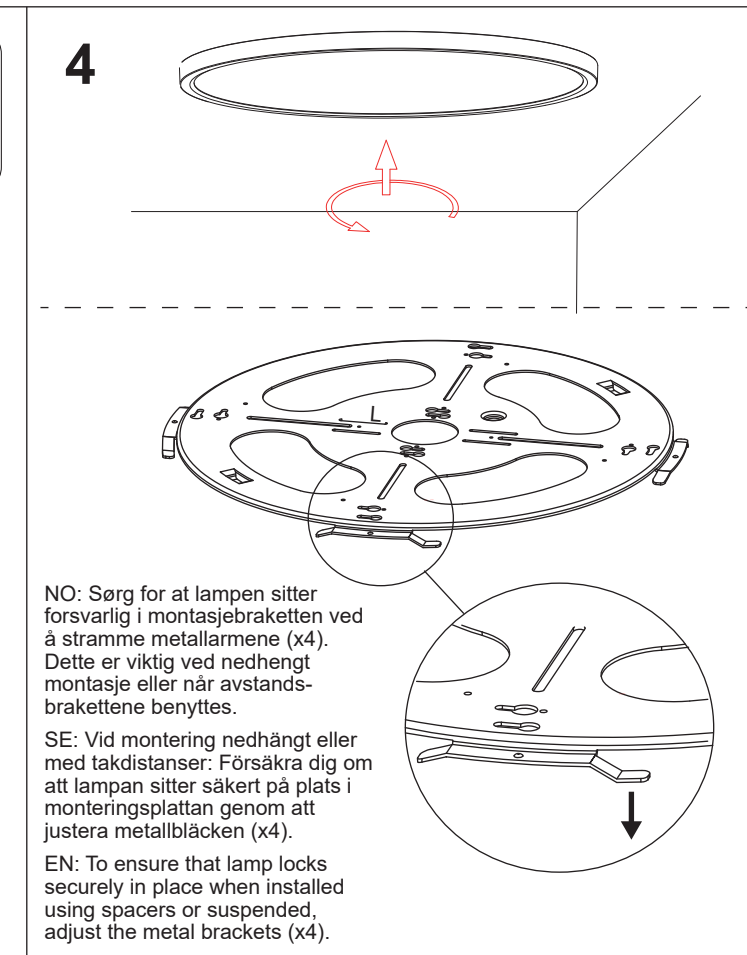
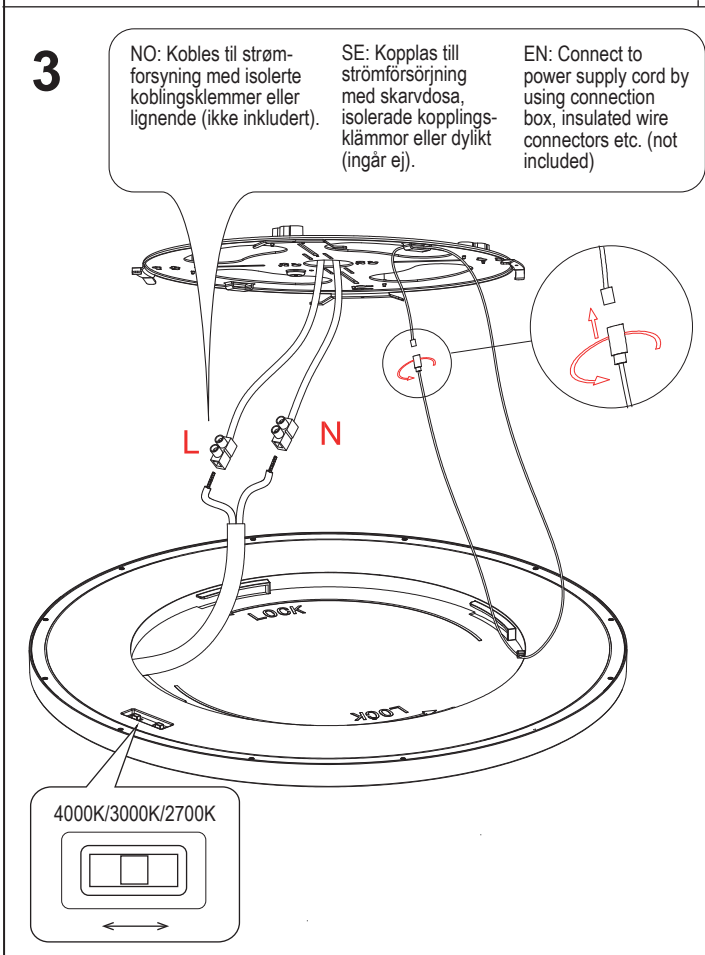
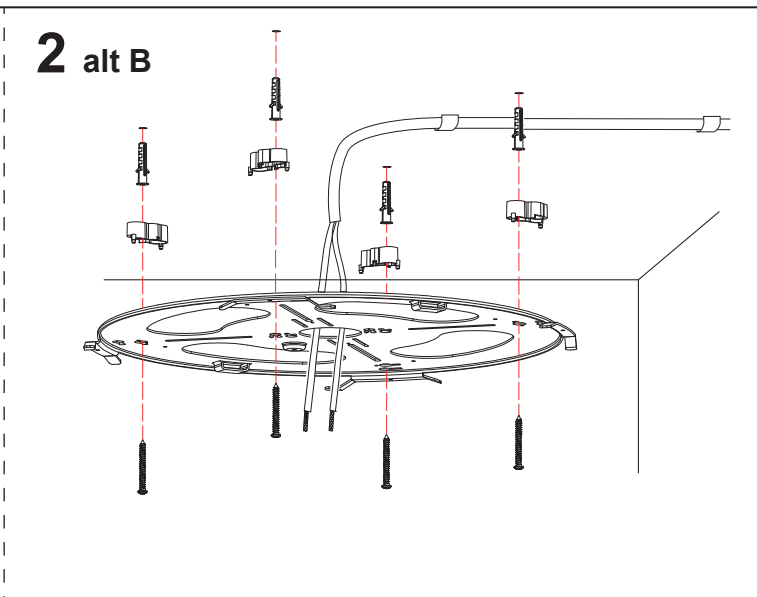
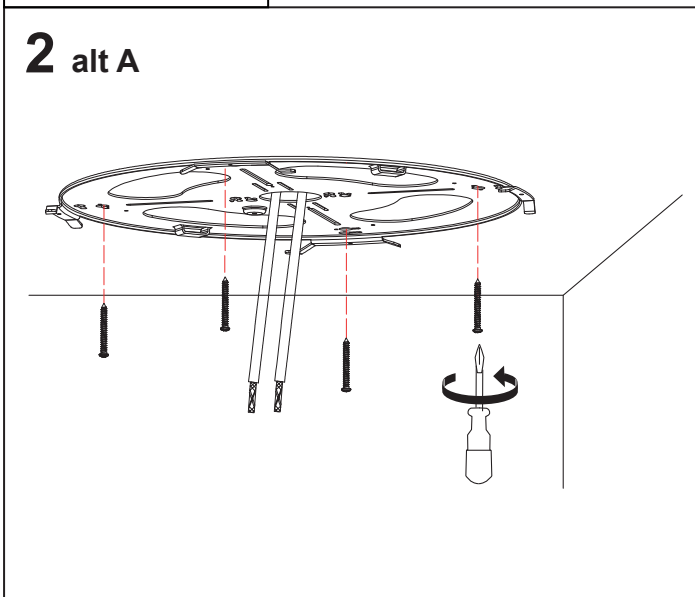
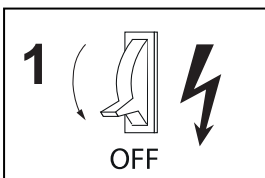

RING 36/600 typ 71204

**ANETA**  
**LIGHTING**  
LIGHTS FOR HOME AND WORK SINCE 1947

SE: Kan monteres som pendel  
med wireoppheng  
RING 36/600 WIRE  
artikkelnr. 71205-70 (hvit)  
eller 71205-15 (sort).

SE: Kan monteras som pendel  
med vajerupphäng  
RING 36/600 WIRE  
artikkelnr. 71205-70 (vit)  
eller 71205-15 (svart).

EN: Can be mounted as  
pendant with wire suspension  
RING 36/600 WIRE  
Item No. 71205-70 (white)  
or 71205-15 (black).

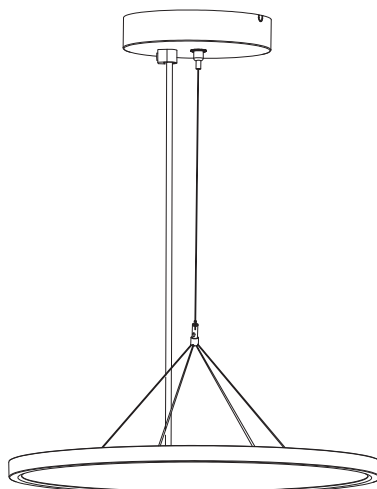

NO: LED-lyskilden og driveren i armaturen er ikke utskiftbare siden de er integrert i konstruksjonen. Når armaturens levetid er slutt skal den byttes ut og leveres til gjenvinning. 50 000 timer  $\approx$  20 år (6 timer/dag)

SE: LED-ljuskällan och drivdonet i armaturen är inte utbytbar, när ljuskällans livstid är slut ska hela armaturen bytas och lämnas till återvinning. 50 000 timmar  $\approx$  20 år (6 timmar/dag)

FI: Valaisimen LED-valonlähde sekä LED-virtalähde ei voi vaihtaa koska ne on integroitu rakenteeseen. Kun valaisin saavuttaa käyttöikänsä loppuun, se on korvattava uudella ja jätettävä ierrätettäväksi. 50 000 tuntia  $\approx$  20 vuotta (6 t/päivä)

EN: The LED light source and the control gear in the luminaire are not replaceable as they are integrated in the construction. When the luminaire reaches the end of its lifetime it shall be replaced and left for recycling. 50 000 h  $\approx$  20 years (6 h/day)

71204-70 NO: Dette produktet inneholder en lyskilde med energieffektivitetsklasse E.

71204-15 SE: Denna produkt innehåller en ljuskälla med energieffektivitetsklass E

FI: Tämä tuote sisältää valonlähteen, jonka energiatehokkuusluokka on E

EN: This product contains a light source of energy efficiency class E

Light Source data:

Lighting technology used: .....	LED	CCT colour temperature:.....	2700 / 3000 / 4000 K
Mains or non-mains: .....	non-mains	SDCM: .....	$\leq$ 4
Directional or non-directional: .....	non-directional	On-mode power: .....	36 W
Connected L.S.: .....	no	Stand-by power: .....	N/A
Color-tuneable: .....	no	Networked standby power: .....	N/A
Envelope: .....	no	CRI: .....	$\geq$ 80
High luminance: .....	no	R9 color rendering index: .....	$>$ 0
Anti-glare shield: .....	no	Chromaticity coordinates (X, Y): ...	2700K: 0.463, 0.420
Dimmable: .....	yes		3000K: 0.440, 0.403
Energy consumption in on-mode: .	36 kWh / 1000 h		4000K: 0.380, 0.380
Energy efficiency class (A-G): .....	E	Lifetime $L_{70B_{50}}$ : .....	50 000 hours
Useful luminous flux:.....	2700K: 4600 lm *	Flicker metric (Pst LM): .....	$<$ 1
	3000K: 4900 lm *	Stroboscopic effect: .....	$<$ 0.4
	4000K: 4900 lm *	Lumen maintenance factor: .....	0.96
		Survival factor: .....	0.9

\* The luminous flux stated here is the value for the light source itself in accordance with Regulation (EU) 2019/2015. The luminous flux stated on the packing box is for the lighting fitting, where the light from the light source is partly absorbed by glass/glare shield/shade and parts of the fitting, and is therefore lower than for the light source.