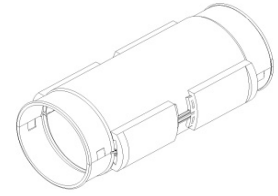

Technical datasheet for:

**RM 110**

### General data

<b>Item</b>	Repairing sleeves	
<b>Description</b>	The divided repairing sleeve RM is the perfect choice to repair light damages of unoccupied ducts or ducts occupied with cables. It is gas- and water-tight up to 0.5 bar.	
<b>Package unit</b>	12 Pcs.	
<b>Transport and storage temperature</b>	-40 to +65	°C
<b>Laying or installation temperature</b>	+5 to +40	°C
<b>Operating temperature</b>	-10 to +50	°C

### Technical data

Quality	Value	Unit
<b>Material</b>	PolyVinylChlorid - Unplastinized PVC-U	
<b>Dimension</b>	d = 110; L = 300	mm
<b>Pressure</b>	0.5	bar
<b>Pressing operation clamp on case</b>	min. 3250	N

**gabocom is certified by the quality system following DIN EN ISO 9001, the environmental management system DIN EN ISO 14001 and the energy management system DIN EN 50001.**

**The used materials meet the REACH default (EU regulation 1907/2006) and the RoHS default (EU guidelines 2011/65).**

gabo Systemtechnik GmbH  
 Am Schaidweg 7  
 94559 Niederwinkling  
 GERMANY

Tel. +49 9962 950-200  
 Fax +49 9962 950-202  
 info@gabocom.com  
 www.gabocom.com

Editor: CBR  
 Release: MK  
 Date: 08.05.2023  
 Edition: 3

No responsibility is taken for the currency and completeness of details and information. This document can be revised and supplemented without prior notice. Liability for damages is excluded.