



G010203

# Combined Optical Smoke and Heat Detector

## CN-PYH

Part no. 5100499-00A

System: CS3000\*, CS4000\*, NSAC-I\*, TERRA FIRE,  
TERRA ONE

### General Description

CN-PYH is an analogue addressable combined optical smoke and heat detector.

This unit can either be used as a smoke, a heat or a combined smoke and heat detector. The following functions can be configured in the Fire detection systems Terra One and Terra Fire:

- The detector address in the system
- Mode (Dual, Multi-criteria, Smoke, Heat or Default)
- Smoke sensitivity level (5 steps)
- Heat sensitivity level (select temperature class AIR, A2S, BS or CS)

CN-PYH is equipped with OMNIVIEW 360° LED indicator giving a clear, full 360° visibility of the red alarm indication. The detector is also equipped with an output for remote indication.

CN-PYH has a fine pitch net which improves the response to smoke and also reduces the amount of dust etc. entering the detector.

The technical detector address is set with a special programming tool. Valid addresses are 1-254.

See separate document "Base matrix" for information about suitable base plate.



#### NOTE!

\* In Fire systems CS3000, CS4000 and NSAC-I, the CN-PYH will have the same functionality as a CN-PH, i.e. a CN-PYH can be used as spare part/replacement for a CN-PH but it will not provide any additional features.

### Data

Sensor method	Light Scatter and Thermistor
Sensor element	1 x Light Emitting Diode and Thermistor
Nominal voltage	35 VDC
Working voltage	20–38 VDC
Working current	200 µA
Alarm current	5 mA (LED)
Remote indication	2 mA
Operating temperature	-10°C to +55°C
Storage temperature	-25°C to +70°C
Relative humidity	≤RH95% non-condensing
Ingress protection	IP40
Addressing method	Soft addressing, Non-Volatile EEPROM.
Material	PC/ABS or ABS
Weight (w/o base)	110 g
Colour	White
Programming tool	Part no. 040300
CE Conformity	EN54-5, EN54-7, EN54-29
Certified according to	 0359-CPR-00278 DoP No: 00278-PYH



#### NOTE!

Do not remove the dust cover from the detector until all polluting (dusty) activities are finished and the area has been cleaned.

### Connection



#### Hint!

For connection, please refer to the data sheet for the selected base plate.

## Dimensions (mm)

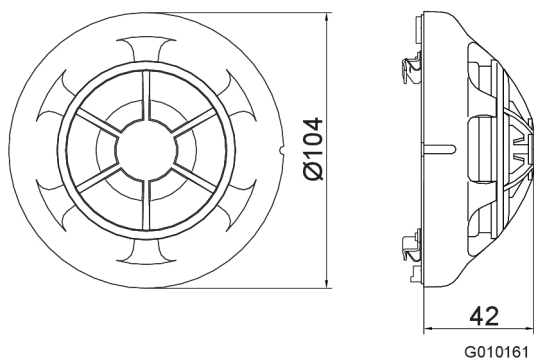

Detector head  $\varnothing 104$  mm x 42 mm

Detector head and UB series base  $\varnothing 104$  mm x 57mm