



CoreLine Wall-mounted

WL140V LED12S/830 PSR MDU WH

Power supply unit - Symmetrical - 120° x 120°

CoreLine Wall-mounted delivers on the CoreLine promise of innovative, easy-to-install and high quality luminaires. It is a circular-shaped surface mounted luminaire for both ceiling and wall installations. It is easy to apply in circulation areas such as hallways and staircases. The modern unobtrusive design, in combination with its homogeneous light distribution, ensures that this luminaire blends into most building architectures. With the push-in connectors, installation is fast and straightforward. This family includes InterAct Ready luminaires with integrated wireless communications, ready for use with InterAct gateways, sensors and software.

Product data

General Information			
Beam angle of light source	120 °	Flammability mark	-
Light source color	830 warm white	CE mark	CE mark
Light source replaceable	Yes	ENEC mark	ENEC mark
Number of gear units	1 unit	Warranty period	5 years
Driver/power unit/transformer	Power supply unit	Constant light output	No
Driver included	Yes	Number of products on MCB of 16 A type B	32
Optic type	Symmetrical	Photobiological risk	Photobiological risk group 0 @ 200mm to EN62471
Luminaire light beam spread	120° x 120°	Photobiological risk specification	0.2 m
Control interface	-	EU RoHS compliant	Yes
Connection	Push-in connector 6-pole	Unified glare rating CEN	22
Cable	-		
Protection class IEC	Safety class II		
Glow-wire test	Temperature 850 °C, duration 30 s		

CoreLine Wall-mounted

Light Technical

Saturated Red (R9)	<50
--------------------	-----

Operating and Electrical

Input Voltage	220-240 V
Input Frequency	50 or 60 Hz
Initial CLO power consumption	- W
Average CLO power consumption	- W
Inrush current	10 A
Inrush time	0.066 ms
Power Factor (Min)	0.9

Controls and Dimming

Dimmable	Yes
----------	-----

Mechanical and Housing

Housing Material	Polycarbonate
Reflector material	Polycarbonate
Optic material	Polycarbonate
Optical cover/lens material	Polycarbonate
Fixation material	-
Optical cover/lens finish	Opal
Overall height	85 mm
Overall diameter	390 mm
Color	White RAL 9003
Dimensions (Height x Width x Depth)	85 x NaN x NaN mm (3.3 x NaN x NaN in)

Approval and Application

Ingress protection code	IP65 [Dust penetration-protected, jet-proof]
Mech. impact protection code	IK10 [20 J vandal-resistant]

Initial Performance (IEC Compliant)

Initial luminous flux (system flux)	1200 lm
-------------------------------------	---------

Luminous flux tolerance	+/-10%
Initial LED luminaire efficacy	90 lm/W
Init. Corr. Color Temperature	3000 K
Init. Color Rendering Index	>80
Initial chromaticity	(0.4338,0.4030) SDCM <3
Initial input power	12 W
Power consumption tolerance	+/-10%

Over Time Performance (IEC Compliant)

Control gear failure rate at median useful life	5 %
50000 h	
Lumen maintenance at median useful life*	80
50000 h	

Application Conditions

Ambient temperature range	-20 to +40 °C
Performance ambient temperature Tq	25 °C
Maximum dim level	10%
Suitable for random switching	No

Product Data

Full product code	871951453082999
Order product name	WL140V LED12S/830 PSR MDU WH
EAN/UPC - Product	8719514530829
Order code	911401851582
Numerator - Quantity Per Pack	1
Numerator - Packs per outer box	6
Material Nr. (12NC)	911401851582
Net Weight (Piece)	1.600 kg



Dimensional drawing

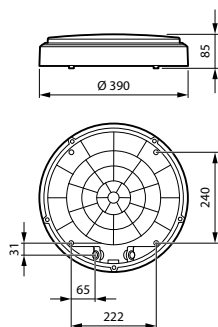

Coreline Wall-mounted WL140V

CoreLine Wall-mounted

