



Part no. : 131A

Receptacle

internal fixing, 1 cable entry at top and two blind cable entries (can be cut out) at bottom, bottom part of enclosure can be turned 180°, with 6 blind holes for mounting special terminals if required

Sleeves: SoftCONTACT

Contact carrier: Highly heat resistant

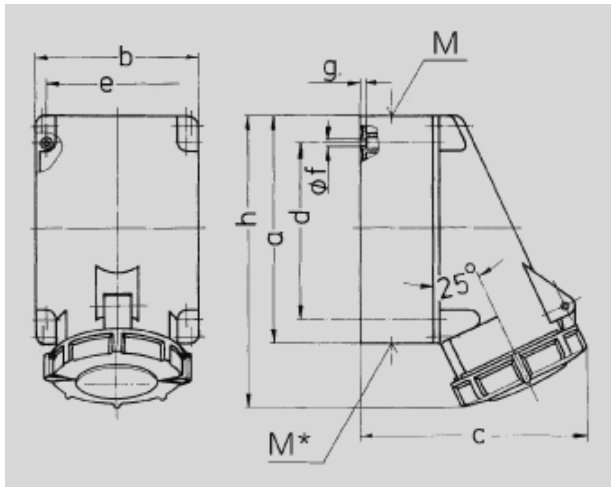

Drawing	Amp. Poles	63		
		3	4	5
1 MB 112				
Dim. in mm	a	170	170	170
	b	118	118	118
	c	171	171	171
	d	134,5	134,5	134,5
	e	103	103	103
	f	6,1	6,1	6,1
	g	6	6	6
	h	216	216	216
	M	40	40	40
	M*	2xM40 (blind) to be cut out		
	Max. cable diam. (mm)	32	32	32
	Terminal for cond. cross section (mm ²) min.-max.	6 —25	6 —25	6 —25

 Article-group : **1049**

voltages : 230V

rated current : 63A

pole : 4 pole







IP protection types : IP67

position of ground contact : 9h

packing unit : 0005

weight : 920 g

PART NUMBERS

V	110V	230V	400V	500V	>50-500V	
Hz	50,60	50,60	50,60	50,60	100-300	300-500
colour						
amp.						
63 A	3	856	128A	129A		
	4	130A	131A	132A	133A	
	5	134A	135A	136A	2007A	